

DAFTAR PUSTAKA

- Bentley System, Inc. 2012, "SACS Program Manual"
- Bureau Veritas Classification, 2015 "Lifting Units Rule Note NR 608 DT R00 E"
- Chakrabarti S K. 2005, "Handbook of Offshore Engineering vol I". USA
- Chakrabarti S K. 2005, "Handbook of Offshore Engineering vol II". USA
- Chlemet, Chima. 2015, "Offshore Heavy Lift Design and Operations : Sling Tension in Heavy Lifts with Quadruple Sling Arrangement". University of Aberdeen
- DNVGL-ST-N001. 2016, "Marine operation and marine warranty"
- DNV-OS-H205. 2014, "Lifting Operation (VMO Standard – Part 2 -5)
- EI-Reedy, M. A., 2015, "Marine Structural Design Calculation". USA
- H. Pallipui dan S. Ramadhan. 2020, "Lifting analysis of Mooring Support Structure (MSS) in offshore tower yoke by top panel stacking structure method", IOP Conference Series: Earth and Environmental Science. Makassar
- Speight, J. G., 2015, "Handbook of Offshore and Gas Operation". Wyomi. USA
- Hetland, S. H., 2016, "HSE DIRECTIVE LIFTING OPERATIONS"
- IHSA, 2020 "Hoisting and Rigging Safety Manual". Kanada
- International Marine Contractors Association, 2017 "Guidelines of Lifting Operations"
- Juswan, dan Taufiqur Rahman. 2003, "Struktur Bangunan Laut". Penulisan Buku Ajar Proyek Kerjasama Segitiga Biru (ITS – UNHAS – UNPATTI). Makassar
- Liang, Li. 2004, "Heavy Lift Installation Study of Offshore". Department of Civil Engineering National University of Singapore. Singapore
- Misra, S. C., 2016 "Design Principles of Ships and Marine Structures" USA
- NSL Community Safety, 2008, "The International Rigging & Lifting Handbook"
- Priyo Hartono, Trijeti. 2015, "Studi Analisis Penggunaan Analisis Penggunaan Alat Berat Crane Sebagai Alat Angkat Untuk Instalasi Equipment Deodorizer di Proyek CPO Plant". Universitas Muhammadiyah Jakarta
- Reddy, D. V., dan Swamidas, A. S. J., 2014, " Essentials of Offshore Structures Frames and Gravity Platforms". USA
- Vladimir Matusek, dan Eva Matusekova. 2015, "The *Centre of Gravity* in Technical Practice". Slovak University of Agriculture, Faculty of Economic and Management, Department of Mathematics. Slovak.

Lampiran 1 SACS MODELING

ISOMETRIC VIEW

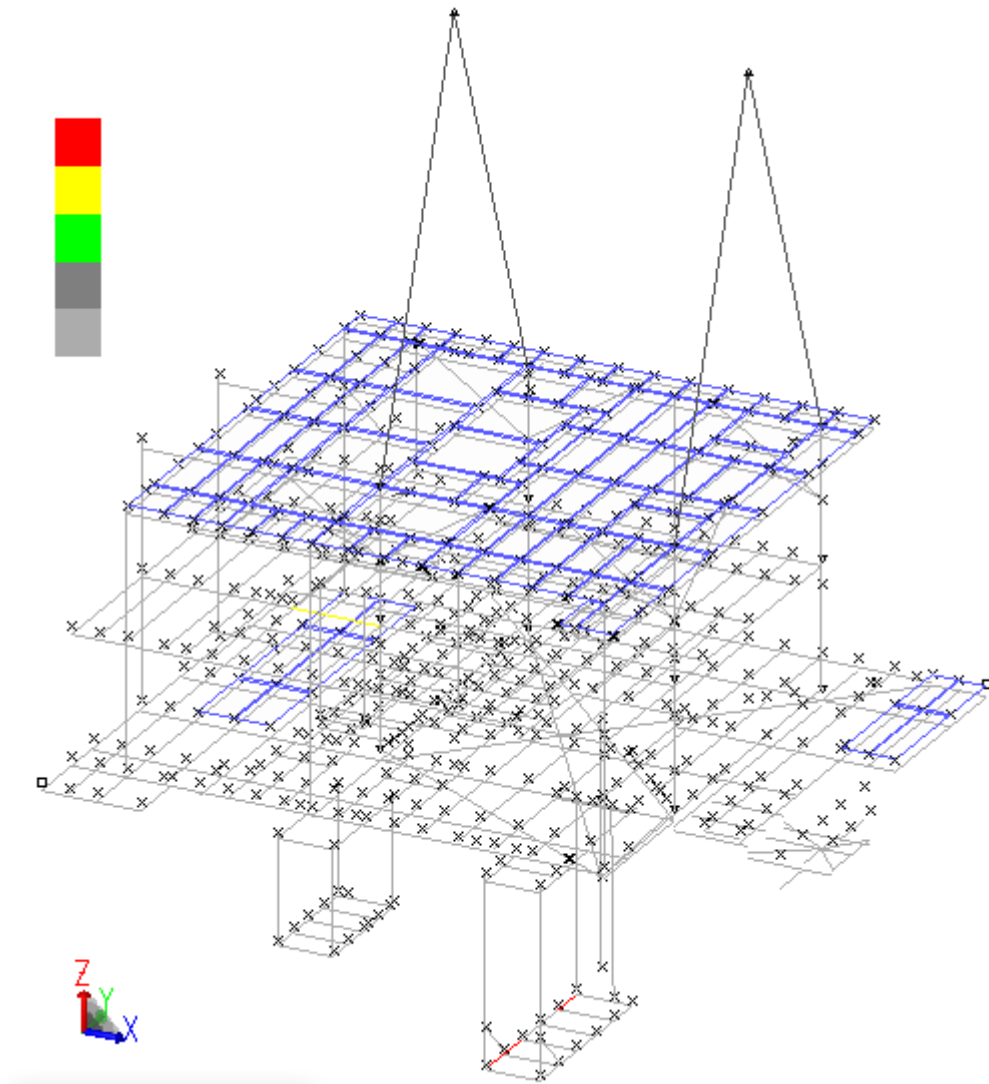

Lampiran 2 SACS INPUT

SACS INPUT NO SHIFT

LCOPT	RP*01.0250007.849000	GLOBBN	CMB
OPTIOM	NO	SO4R 4 4	OC C PTFPT PT PTF
LCSEL ST	AP00 RFO0 DRAD		
UCPART	0.8000,8001,0001,000		
SECT			
SECT BOX	NO		
7.1.3953.41042,7381.4531.2701.30			
SECT BOX1	PLG	40.8403.81060.9401.851	
3.81			
GRUP			
GRUP BRD W3EK194	20.007.72234.90	1	1.001.00
7.8490			
GRUP SLG	12.000 4.000 20.007.72224.80	8	1.001.00 0.500
1.00-5			
UBUD PDY	10.000 4.000 20.007.72224.80	8	1.001.00 0.500
1.00-5			
** CELLAR DECK GROUP **			
GRUP CDS W3EK194	20.007.72234.90	1	1.001.00
7.8490			
GRUP CBI W24K148	21.008.00034.90	1	1.001.00
7.8500			
GRUP CD2 W24K76	21.008.00034.90	1	1.001.00
7.8500			
GRUP CD3 W10K22	21.008.00023.90	1	1.001.00
7.8500			
GRUP CD5 BOX1	21.008.00034.90	1	1.001.00
7.8500			
GRUP CD6 W16K45	21.008.00034.90	1	1.001.00
7.8500			
GRUP CD7 BOX	21.008.00034.90	1	1.001.00
7.8500			
** DECK COLUMN GROUP **			
GRUP CL1	76.200 2.500 21.008.00034.90	1	1.001.00 0.500
7.8500			
GRUP CL3	76.200 1.800 21.008.00034.90	1	1.001.00 0.500
7.8500			
** DECK BRACING GROUP **			
GRUP DBH	40.600 1.590 21.008.00034.90	1	1.001.00 0.500
7.8500			
** DECK LBS GROUP **			
GRUP DLI	152.40 2.500 21.008.00034.90	1	1.001.00 0.500
7.8500			
GRUP DLA	152.40 8.000 21.008.00034.90	1	1.001.00 0.500
7.8500			
GRUP DSI	76.200 2.500 21.008.00034.90	1	1.001.00 0.500
7.8500			
*GRUP HSI	21.900 0.900 21.008.00024.80	1	1.001.00 0.500
7.8500			
GRUP HZJ	32.300 1.590 21.008.00024.80	1	1.001.00 0.500
7.8500			
** MAIN DECK GROUP **			
GRUP MDC W24K148	20.008.00034.90	1	1.001.00
7.8490			
GRUP MDI W24K76	21.008.00034.90	1	1.001.00
7.8500			
GRUP MD2 W16K45	21.008.00034.90	1	1.001.00
7.8500			
GRUP MD3 W10K22	21.008.00023.90	1	1.001.00
7.8500			
** SUBCELLAR DECK GROUP **			
GRUP SDI W10K22	21.008.00023.90	1	1.001.00
7.8500			
** WELL HEAD SERVICE DECK GROUP **			
GRUP WDI W16K45	21.008.00034.90	1	1.001.00
7.8500			
GRUP WD2 W10K22	20.007.72223.90	1	1.001.00
7.8490			
MEMBER			
MEMBER120022050 BRD	L 8.00		
MEMBER OFFSETS	-45.72	-45.72	
MEMBER12048BR11 BRD	L 4.00		
MEMBER OFFSETS	-45.72	-45.72	
MEMBER120502051 BRD	L 4.00		
MEMBER OFFSETS	-45.72	-45.72	
MEMBER121600909 BRD	L		
MEMBER OFFSETS	-45.72	-45.72	
MEMBER1BR02BR01 BRD	L 4.00		
MEMBER OFFSETS	-45.72	-45.72	
MEMBER1BR03BR02 BRD	L 4.00		
MEMBER OFFSETS	-45.72	-45.72	
MEMBER1BR04BR03 BRD	L		
MEMBER OFFSETS	-45.72	-45.72	
MEMBER1BR05BR10 BRD	L		
MEMBER OFFSETS	-45.72	-45.72	
MEMBER1BR102048 BRD	L 4.00		
MEMBER OFFSETS	-45.72	-45.72	
MEMBER1BR11BR04 BRD	L 4.00		
MEMBER OFFSETS	-45.72	-45.72	
MEMBER12002BR03 CO0	L 8.00		
MEMBER OFFSETS	-45.72	-45.72	
MEMBER120282029 CO0	L 8.00		
MEMBER OFFSETS	-45.72	-45.72	
MEMBER120282435 CO0	L 8.003.30		
MEMBER OFFSETS	-45.72	-45.72	
MEMBER12030BR10 CO0	L 8.00		
MEMBER OFFSETS	-45.72	-45.72	
MEMBER124552004 CO0	L 8.003.30		

MEMBER OFFSETS	-45.72	-45.72
MEMBER1BR132030 CO0	L 8.00	
MEMBER OFFSETS	-45.72	-45.72
MEMBER1BR102028 CO0	L 8.00	
MEMBER OFFSETS	-45.72	-45.72
MEMBER1185 2032 CO1	L 5.00	
MEMBER OFFSETS	-30.48	-30.48
MEMBER120002131 CO1	L 5.65	
MEMBER OFFSETS	-30.48	-30.48
MEMBER120002132 CO1	L 5.65	
MEMBER OFFSETS	-30.48	-30.48
MEMBER120042054 CO1	L 7.00	
MEMBER OFFSETS	-30.48	-30.48
MEMBER120072311 CO1	L 5.20	
MEMBER OFFSETS	-30.48	-30.48
MEMBER120082024 CO1	L 7.60	
MEMBER OFFSETS	-30.48	-30.48
MEMBER120162038 CO1	L 5.00	
MEMBER OFFSETS	-30.48	-30.48
MEMBER120172056 CO1	L 7.00	
MEMBER OFFSETS	-30.48	-30.48
MEMBER120212018 CO1	L 7.00	
MEMBER OFFSETS	-30.48	-30.48
MEMBER120222021 CO1	L 7.00	
MEMBER OFFSETS	-30.48	-30.48
MEMBER120222109 CO1	L 3.307.30	
MEMBER OFFSETS	-30.48	-30.48
MEMBER120242002 CO1	L 7.60	
MEMBER OFFSETS	-30.48	-30.48
MEMBER120282108 CO1	L 7.00	
MEMBER OFFSETS	-30.48	-30.48
MEMBER120312040 CO1	L 5.00	
MEMBER OFFSETS	-30.48	-30.48
MEMBER120322901 CO1	L 5.00	
MEMBER OFFSETS	-30.48	-30.48
MEMBER120382039 CO1	L 5.00	
MEMBER OFFSETS	-30.48	-30.48
MEMBER120392031 CO1	L 5.00	
MEMBER OFFSETS	-30.48	-30.48
MEMBER120402041 CO1	L 5.00	
MEMBER OFFSETS	-30.48	-30.48
MEMBER12041185 CO1	L 5.00	
MEMBER OFFSETS	-30.48	-30.48
MEMBER120542401 CO1	L 7.00	
MEMBER OFFSETS	-30.48	-30.48
MEMBER120552011 CO1	L 7.00	
MEMBER OFFSETS	-30.48	-30.48
MEMBER120592105 CO1	L	
MEMBER OFFSETS	-30.48	-30.48
MEMBER120852183 CO1	L 5.052.83	
MEMBER OFFSETS	-30.48	-30.48
MEMBER120882162 CO1	L 2.83	
MEMBER OFFSETS	-30.48	-30.48
MEMBER121052220 CO1	L 3.00	
MEMBER OFFSETS	-30.48	-30.48
MEMBER121082022 CO1	L 7.00	
MEMBER OFFSETS	-30.48	-30.48
MEMBER121092025 CO1	L 3.307.30	
MEMBER OFFSETS	-30.48	-30.48
MEMBER121142105 CO1	L 5.601.40	
MEMBER OFFSETS	-30.48	-30.48
MEMBER121242110 CO1	L 5.601.40	
MEMBER OFFSETS	-30.48	-30.48
MEMBER121312154 CO1	L 5.65	
MEMBER OFFSETS	-30.48	-30.48
MEMBER121322180 CO1	L 5.65	
MEMBER OFFSETS	-30.48	-30.48
MEMBER121332000 CO1	L 5.65	
MEMBER OFFSETS	-30.48	-30.48
MEMBER121342000 CO1	L 5.65	
MEMBER OFFSETS	-30.48	-30.48
MEMBER121562066 CO1	L 5.651.40	
MEMBER OFFSETS	-30.48	-30.48
MEMBER121602067 CO1	L 5.651.40	
MEMBER OFFSETS	-30.48	-30.48
MEMBER121622134 CO1	L 5.65	
MEMBER OFFSETS	-30.48	-30.48
MEMBER121632133 CO1	L 5.65	
MEMBER OFFSETS	-30.48	-30.48
MEMBER122202104 CO1	L 3.00	
MEMBER OFFSETS	-30.48	-30.48
MEMBER123112001 CO1	L 5.20	
MEMBER OFFSETS	-30.48	-30.48
MEMBER120012186 CO2	L 8.00	
MEMBER OFFSETS	-29.21	-29.21
MEMBER120012236 CO2	L 8.00	
MEMBER OFFSETS	-29.21	-29.21
MEMBER120032019 CO2	L 4.00	
MEMBER OFFSETS	-29.21	-29.21
MEMBER120032049 CO2	L 8.00	
MEMBER OFFSETS	-29.21	-29.21
MEMBER120042020 CO2	L 4.00	
MEMBER OFFSETS	-29.21	-29.21
MEMBER12010BR01 CO2	L 1.20	
MEMBER OFFSETS	-29.21	-29.21
MEMBER120122014 CO2	L 5.00	
MEMBER OFFSETS	-29.21	-29.21
MEMBER120132184 CO2	L 5.00	
MEMBER OFFSETS	-29.21	-29.21

MEMBER120142083 CD2	L	5.00		MEMBER OFFSETS		-29.21	-29.21
MEMBER OFFSETS		-29.21	-29.21	MEMBER121552154 CD2	L	2.50	
MEMBER120152190 CD2	L	5.00		MEMBER OFFSETS		-29.21	-29.21
MEMBER OFFSETS		-29.21	-29.21	MEMBER121572240 CD2	L	2.50	
MEMBER120172200 CD2	L			MEMBER OFFSETS		-29.21	-29.21
MEMBER OFFSETS		-29.21	-29.21	MEMBER121642173 CD2	L	8.00	
MEMBER120182054 CD2	L			MEMBER OFFSETS		-29.21	-29.21
MEMBER OFFSETS		-29.21	-29.21	MEMBER121652225 CD2	L	8.00	
MEMBER120112017 CD2	L			MEMBER OFFSETS		-29.21	-29.21
MEMBER OFFSETS		-29.21	-29.21	MEMBER121672183 CD2	L	8.00	
MEMBER120252120 CD2	L	5.00		MEMBER OFFSETS		-29.21	-29.21
MEMBER OFFSETS		-29.21	-29.21	MEMBER121692148 CD2	L	8.00	
MEMBER120278804 CD2	L		1.20	MEMBER OFFSETS		-29.21	-29.21
MEMBER OFFSETS		-29.21	-29.21	MEMBER121742145 CD2	L	8.00	
MEMBER120282112 CD2	L	4.00		MEMBER OFFSETS		-29.21	-29.21
MEMBER OFFSETS		-29.21	-29.21	MEMBER121772182 CD2	L	8.00	
MEMBER120342035 CD2	L	5.00		MEMBER OFFSETS		-29.21	-29.21
MEMBER OFFSETS		-29.21	-29.21	MEMBER121782185 CD2	L	5.00	
MEMBER120352034 CD2	L	5.00		MEMBER OFFSETS		-29.21	-29.21
MEMBER OFFSETS		-29.21	-29.21	MEMBER121792192 CD2	L	5.00	
MEMBER120362037 CD2	L	5.00		MEMBER OFFSETS		-29.21	-29.21
MEMBER OFFSETS		-29.21	-29.21	MEMBER121822168 CD2	L	8.00	
MEMBER120373014 CD2	L	5.00		MEMBER OFFSETS		-29.21	-29.21
MEMBER OFFSETS		-29.21	-29.21	MEMBER121832176 CD2	L	8.00	
MEMBER120382194 CD2	L			MEMBER OFFSETS		-29.21	-29.21
MEMBER OFFSETS		-29.21	-29.21	MEMBER121842003 CD2	L	8.00	
MEMBER120452099 CD2	L	8.00		MEMBER OFFSETS		-29.21	-29.21
MEMBER OFFSETS		-29.21	-29.21	MEMBER121872153 CD2	L	8.00	
MEMBER120512010 CD2	L		1.20	MEMBER OFFSETS		-29.21	-29.21
MEMBER OFFSETS		-29.21	-29.21	MEMBER121892174 CD2	L	5.00	
MEMBER120542104 CD2	L			MEMBER OFFSETS		-29.21	-29.21
MEMBER OFFSETS		-29.21	-29.21	MEMBER121922177 CD2	L	5.00	
MEMBER120602059 CD2	L	8.00		MEMBER OFFSETS		-29.21	-29.21
MEMBER OFFSETS		-29.21	-29.21	MEMBER121942178 CD2	L	5.00	
MEMBER120630270 CD2	L	8.00		MEMBER OFFSETS		-29.21	-29.21
MEMBER OFFSETS		-29.21	-29.21	MEMBER121952194 CD2	L	5.00	
MEMBER120702071 CD2	L	8.00		MEMBER OFFSETS		-29.21	-29.21
MEMBER OFFSETS		-29.21	-29.21	MEMBER121962111 CD2	L	8.00	
MEMBER120712072 CD2	L	8.00		MEMBER OFFSETS		-29.21	-29.21
MEMBER OFFSETS		-29.21	-29.21	MEMBER121972176 CD2	L	5.00	
MEMBER120722073 CD2	L	8.00		MEMBER OFFSETS		-29.21	-29.21
MEMBER OFFSETS		-29.21	-29.21	MEMBER121982193 CD2	L	5.00	
MEMBER120732074 CD2	L	8.00		MEMBER OFFSETS		-29.21	-29.21
MEMBER OFFSETS		-29.21	-29.21	MEMBER122252186 CD2	L	8.00	
MEMBER120742075 CD2	L	8.00		MEMBER OFFSETS		-29.21	-29.21
MEMBER OFFSETS		-29.21	-29.21	MEMBER122262164 CD2	L	8.00	
MEMBER120752004 CD2	L	8.00		MEMBER OFFSETS		-29.21	-29.21
MEMBER OFFSETS		-29.21	-29.21	MEMBER122362187 CD2	L	8.00	
MEMBER120782045 CD2	L	8.00		MEMBER OFFSETS		-29.21	-29.21
MEMBER OFFSETS		-29.21	-29.21	MEMBER122402152 CD2	L	2.50	
MEMBER120782079 CD2	L	8.00		MEMBER OFFSETS		-29.21	-29.21
MEMBER OFFSETS		-29.21	-29.21	MEMBER123102123 CD2	L	5.00	
MEMBER120792080 CD2	L	8.00		MEMBER OFFSETS		-29.21	-29.21
MEMBER OFFSETS		-29.21	-29.21	MEMBER123112099 CD2	L	8.00	
MEMBER120802081 CD2	L	8.00		MEMBER OFFSETS		-29.21	-29.21
MEMBER OFFSETS		-29.21	-29.21	MEMBER124142419 CD2	L		1.23
MEMBER120812082 CD2	L	8.00		MEMBER OFFSETS		-29.21	-29.21
MEMBER OFFSETS		-29.21	-29.21	MEMBER124182318 CD2	L	5.00	
MEMBER120822002 CD2	L	8.00		MEMBER OFFSETS		-29.21	-29.21
MEMBER OFFSETS		-29.21	-29.21	MEMBER124192121 CD2	L		1.23
MEMBER120972096 CD2	L	8.00		MEMBER OFFSETS		-29.21	-29.21
MEMBER OFFSETS		-29.21	-29.21	MEMBER124212027 CD2	L		1.20
MEMBER120982045 CD2	L	8.00		MEMBER OFFSETS		-29.21	-29.21
MEMBER OFFSETS		-29.21	-29.21	MEMBER12422051 CD2	L		
MEMBER120992100 CD2	L	8.00		MEMBER OFFSETS		-29.21	-29.21
MEMBER OFFSETS		-29.21	-29.21	MEMBER124232113 CD2	L		
MEMBER121002181 CD2	L	8.00		MEMBER OFFSETS		-29.21	-29.21
MEMBER OFFSETS		-29.21	-29.21	MEMBER124242050 CD2	L		
MEMBER121012182 CD2	L	8.00		MEMBER OFFSETS		-29.21	-29.21
MEMBER OFFSETS		-29.21	-29.21	MEMBER124252183 CD3	L		
MEMBER121022183 CD2	L	8.00		MEMBER OFFSETS		-12.70	-12.70
MEMBER OFFSETS		-29.21	-29.21	MEMBER120092188 CD3	L		
MEMBER121032024 CD2	L	8.00		MEMBER OFFSETS		-12.70	-12.70
MEMBER OFFSETS		-29.21	-29.21	MEMBER120142206 CD3	L		
MEMBER121112059 CD2	L	8.00		MEMBER OFFSETS		-12.70	-12.70
MEMBER OFFSETS		-29.21	-29.21	MEMBER120432032 CD3	L	2.83	
MEMBER121122113 CD2	L	4.00		MEMBER OFFSETS		-12.70	-12.70
MEMBER OFFSETS		-29.21	-29.21	MEMBER120442123 CD3	L		
MEMBER121132022 CD2	L			MEMBER OFFSETS		-12.70	-12.70
MEMBER OFFSETS		-29.21	-29.21	MEMBER120452119 CD3	L	2.57	
MEMBER121202121 CD2	L	5.00		MEMBER OFFSETS		-12.70	-12.70
MEMBER OFFSETS		-29.21	-29.21	MEMBER120462045 CD3	L		
MEMBER121212039 CD2	L	2.84		MEMBER OFFSETS		-12.70	-12.70
MEMBER OFFSETS		-29.21	-29.21	MEMBER120472146 CD3	L	2.50	
MEMBER121212418 CD2	L	5.00		MEMBER OFFSETS		-12.70	-12.70
MEMBER OFFSETS		-29.21	-29.21	MEMBER120932048 CD3	L		
MEMBER121222111 CD2	L	5.00		MEMBER OFFSETS		-12.70	-12.70
MEMBER OFFSETS		-29.21	-29.21	MEMBER120932057 CD3	L		
MEMBER121402147 CD2	L	8.00		MEMBER OFFSETS		-12.70	-12.70
MEMBER OFFSETS		-29.21	-29.21	MEMBER120542117 CD3	L		
MEMBER121502157 CD2	L	2.50		MEMBER OFFSETS		-12.70	-12.70
MEMBER OFFSETS		-29.21	-29.21	MEMBER120572058 CD3	L		
MEMBER121512155 CD2	L	2.50		MEMBER OFFSETS		-12.70	-12.70
MEMBER OFFSETS		-29.21	-29.21	MEMBER120592182 CD3	L		
MEMBER121522029 CD2	L	2.00		MEMBER OFFSETS		-12.70	-12.70
MEMBER OFFSETS		-29.21	-29.21	MEMBER120492090 CD3	L		
MEMBER121532224 CD2	L	8.00		MEMBER OFFSETS		-12.70	-12.70
MEMBER OFFSETS		-29.21	-29.21	MEMBER120702091 CD3	L		
MEMBER121542028 CD2	L	2.50		MEMBER OFFSETS		-12.70	-12.70

MEMBER12012092 CO3	L			MEMBER OFFSETS	-12.70	-12.70
MEMBER OFFSETS	L	-12.70	-12.70	MEMBER121572158 CO3	L	-12.70
MEMBER120722093 CO3	L	-12.70	-12.70	MEMBER OFFSETS	-12.70	-12.70
MEMBER OFFSETS	L	-12.70	-12.70	MEMBER121582074 CO3	L	-12.70
MEMBER121132094 CO3	L	-12.70	-12.70	MEMBER OFFSETS	-12.70	-12.70
MEMBER OFFSETS	L	-12.70	-12.70	MEMBER121602155 CO3	L	-12.70
MEMBER120742095 CO3	L	-12.70	-12.70	MEMBER OFFSETS	-12.70	-12.70
MEMBER OFFSETS	L	-12.70	-12.70	MEMBER121610009 CO3	L	-12.70
MEMBER120752096 CO3	L	-12.70	-12.70	MEMBER OFFSETS	-12.70	-12.70
MEMBER OFFSETS	L	-12.70	-12.70	MEMBER121622142 CO3	L	1.34
MEMBER12162149 CO3	L	-12.70	-12.70	MEMBER OFFSETS	-12.70	-12.70
MEMBER OFFSETS	L	-12.70	-12.70	MEMBER121632070 CO3	L	-12.70
MEMBER120792138 CO3	L	-12.70	-12.70	MEMBER OFFSETS	-12.70	-12.70
MEMBER OFFSETS	L	-12.70	-12.70	MEMBER121642175 CO3	L	2.00
MEMBER120802041 CO3	L	2.50	-12.70	MEMBER OFFSETS	-12.70	-12.70
MEMBER OFFSETS	L	-12.70	-12.70	MEMBER121652171 CO3	L	2.00
MEMBER120812009 CO3	L	-12.70	-12.70	MEMBER OFFSETS	-12.70	-12.70
MEMBER OFFSETS	L	-12.70	-12.70	MEMBER121662149 CO3	L	1.34
MEMBER120832097 CO3	L	-12.70	-12.70	MEMBER OFFSETS	-12.70	-12.70
MEMBER OFFSETS	L	-12.70	-12.70	MEMBER121682170 CO3	L	2.30
MEMBER120842098 CO3	L	-12.70	-12.70	MEMBER OFFSETS	-12.70	-12.70
MEMBER OFFSETS	L	-12.70	-12.70	MEMBER121672173 CO3	L	2.50
MEMBER120852099 CO3	L	-12.70	-12.70	MEMBER OFFSETS	-12.70	-12.70
MEMBER OFFSETS	L	-12.70	-12.70	MEMBER121682172 CO3	L	2.30
MEMBER120862000 CO3	L	-12.70	-12.70	MEMBER OFFSETS	-12.70	-12.70
MEMBER OFFSETS	L	-12.70	-12.70	MEMBER121692174 CO3	L	2.50
MEMBER120872101 CO3	L	-12.70	-12.70	MEMBER OFFSETS	-12.70	-12.70
MEMBER OFFSETS	L	-12.70	-12.70	MEMBER121702129 CO3	L	2.00
MEMBER120882102 CO3	L	-12.70	-12.70	MEMBER OFFSETS	-12.70	-12.70
MEMBER OFFSETS	L	-12.70	-12.70	MEMBER121722129 CO3	L	2.30
MEMBER120892103 CO3	L	-12.70	-12.70	MEMBER OFFSETS	-12.70	-12.70
MEMBER OFFSETS	L	-12.70	-12.70	MEMBER121732144 CO3	L	2.34
MEMBER120902122 CO3	L	2.57	-12.70	MEMBER OFFSETS	-12.70	-12.70
MEMBER OFFSETS	L	-12.70	-12.70	MEMBER121742130 CO3	L	2.30
MEMBER1209120 CO3	L	-12.70	-12.70	MEMBER OFFSETS	-12.70	-12.70
MEMBER OFFSETS	L	-12.70	-12.70	MEMBER121752141 CO3	L	2.00
MEMBER1209220 CO3	L	-12.70	-12.70	MEMBER OFFSETS	-12.70	-12.70
MEMBER OFFSETS	L	-12.70	-12.70	MEMBER121762143 CO3	L	1.34
MEMBER120932079 CO3	L	-12.70	-12.70	MEMBER OFFSETS	-12.70	-12.70
MEMBER OFFSETS	L	-12.70	-12.70	MEMBER121802188 CO3	L	2.00
MEMBER121012080 CO3	L	-12.70	-12.70	MEMBER OFFSETS	-12.70	-12.70
MEMBER OFFSETS	L	-12.70	-12.70	MEMBER121812193 CO3	L	-12.70
MEMBER121022081 CO3	L	-12.70	-12.70	MEMBER OFFSETS	-12.70	-12.70
MEMBER OFFSETS	L	-12.70	-12.70	MEMBER121822190 CO3	L	2.00
MEMBER121032082 CO3	L	-12.70	-12.70	MEMBER OFFSETS	-12.70	-12.70
MEMBER OFFSETS	L	-12.70	-12.70	MEMBER121832191 CO3	L	2.00
MEMBER121042115 CO3	L	2.00, 2.30	-12.70	MEMBER OFFSETS	-12.70	-12.70
MEMBER OFFSETS	L	-12.70	-12.70	MEMBER121842197 CO3	L	-12.70
MEMBER121110 CO3	L	-12.70	-12.70	MEMBER OFFSETS	-12.70	-12.70
MEMBER OFFSETS	L	-12.70	-12.70	MEMBER121882196 CO3	L	2.00
MEMBER12112209 CO3	L	-12.70	-12.70	MEMBER OFFSETS	-12.70	-12.70
MEMBER OFFSETS	L	-12.70	-12.70	MEMBER121892229 CO3	L	-12.70
MEMBER1211308 CO3	L	-12.70	-12.70	MEMBER OFFSETS	-12.70	-12.70
MEMBER OFFSETS	L	-12.70	-12.70	MEMBER121902229 CO3	L	-12.70
MEMBER121140060 CO3	L	2.57	-12.70	MEMBER OFFSETS	-12.70	-12.70
MEMBER OFFSETS	L	-12.70	-12.70	MEMBER121912183 CO3	L	2.00
MEMBER1211500 CO3	L	-12.70	-12.70	MEMBER OFFSETS	-12.70	-12.70
MEMBER OFFSETS	L	-12.70	-12.70	MEMBER121922199 CO3	L	-12.70
MEMBER1211600 CO3	L	-12.70	-12.70	MEMBER OFFSETS	-12.70	-12.70
MEMBER OFFSETS	L	-12.70	-12.70	MEMBER121932199 CO3	L	-12.70
MEMBER121170194 CO3	L	2.57	-12.70	MEMBER OFFSETS	-12.70	-12.70
MEMBER OFFSETS	L	-12.70	-12.70	MEMBER121932207 CO3	L	-12.70
MEMBER12118204 CO3	L	2.57	-12.70	MEMBER OFFSETS	-12.70	-12.70
MEMBER OFFSETS	L	-12.70	-12.70	MEMBER121942182 CO3	L	2.00
MEMBER121192163 CO3	L	2.00	-12.70	MEMBER OFFSETS	-12.70	-12.70
MEMBER OFFSETS	L	-12.70	-12.70	MEMBER121952228 CO3	L	-12.70
MEMBER121202144 CO3	L	2.30	-12.70	MEMBER OFFSETS	-12.70	-12.70
MEMBER OFFSETS	L	-12.70	-12.70	MEMBER121962191 CO3	L	-12.70
MEMBER1212120 CO3	L	-12.70	-12.70	MEMBER OFFSETS	-12.70	-12.70
MEMBER OFFSETS	L	-12.70	-12.70	MEMBER121972187 CO3	L	-12.70
MEMBER121222194 CO3	L	2.50	-12.70	MEMBER OFFSETS	-12.70	-12.70
MEMBER OFFSETS	L	-12.70	-12.70	MEMBER121982207 CO3	L	-12.70
MEMBER12123205 CO3	L	3.00, 2.00	-12.70	MEMBER OFFSETS	-12.70	-12.70
MEMBER OFFSETS	L	-12.70	-12.70	MEMBER122042127 CO3	L	-12.70
MEMBER121242072 CO3	L	-12.70	-12.70	MEMBER OFFSETS	-12.70	-12.70
MEMBER OFFSETS	L	-12.70	-12.70	MEMBER122112041 CO3	L	-12.70
MEMBER121412142 CO3	L	2.00	-12.70	MEMBER OFFSETS	-12.70	-12.70
MEMBER OFFSETS	L	-12.70	-12.70	MEMBER122112043 CO3	L	-12.70
MEMBER12141211 CO3	L	-12.70	-12.70	MEMBER OFFSETS	-12.70	-12.70
MEMBER OFFSETS	L	-12.70	-12.70	MEMBER122112104 CO3	L	-12.70
MEMBER121422149 CO3	L	1.34	-12.70	MEMBER OFFSETS	-12.70	-12.70
MEMBER OFFSETS	L	-12.70	-12.70	MEMBER122202209 CO3	L	-12.70
MEMBER121432174 CO3	L	1.34	-12.70	MEMBER OFFSETS	-12.70	-12.70
MEMBER OFFSETS	L	-12.70	-12.70	MEMBER122232208 CO3	L	-12.70
MEMBER121432231 CO3	L	-12.70	-12.70	MEMBER OFFSETS	-12.70	-12.70
MEMBER OFFSETS	L	-12.70	-12.70	MEMBER122242227 CO3	L	2.00
MEMBER121442172 CO3	L	1.34	-12.70	MEMBER OFFSETS	-12.70	-12.70
MEMBER OFFSETS	L	-12.70	-12.70	MEMBER122272193 CO3	L	-12.70
MEMBER121442230 CO3	L	-12.70	-12.70	MEMBER OFFSETS	-12.70	-12.70
MEMBER OFFSETS	L	-12.70	-12.70	MEMBER122272226 CO3	L	2.00
MEMBER121452073 CO3	L	-12.70	-12.70	MEMBER OFFSETS	-12.70	-12.70
MEMBER OFFSETS	L	-12.70	-12.70	MEMBER122282140 CO3	L	-12.70
MEMBER121472071 CO3	L	-12.70	-12.70	MEMBER OFFSETS	-12.70	-12.70
MEMBER OFFSETS	L	-12.70	-12.70	MEMBER122292225 CO3	L	-12.70
MEMBER121492163 CO3	L	1.34	-12.70	MEMBER OFFSETS	-12.70	-12.70
MEMBER OFFSETS	L	-12.70	-12.70	MEMBER122302228 CO3	L	-12.70
MEMBER121522199 CO3	L	-12.70	-12.70	MEMBER OFFSETS	-12.70	-12.70
MEMBER OFFSETS	L	-12.70	-12.70	MEMBER122302149 CO3	L	-12.70
MEMBER121542152 CO3	L	-12.70	-12.70	MEMBER OFFSETS	-12.70	-12.70
MEMBER OFFSETS	L	-12.70	-12.70	MEMBER122312130 CO3	L	-12.70
MEMBER121552157 CO3	L	-12.70	-12.70	MEMBER OFFSETS	-12.70	-12.70

MEMBER12412415 CD4	180.00	1	5.00		MEMBER140214183 MD0	1	2.00	1.000	
MEMBER OFFSETS			-20.32	-20.32	MEMBER OFFSETS		-30.35		-30.35
MEMBER124152416 CD4	180.00	1	5.00		MEMBER140114109 MD0	1	2.00	1.000	
MEMBER OFFSETS			-20.32	-20.32	MEMBER OFFSETS		-30.35		-30.35
MEMBER124152419 CD4		1			MEMBER140544093 MD0	1	2.00	1.000	
MEMBER OFFSETS			-20.32	-20.32	MEMBER OFFSETS		-30.35		-30.35
MEMBER124142044 CD4	180.00	1	5.00		MEMBER140044214 MD0	1	2.00,9001.000		-30.35
MEMBER OFFSETS			-20.32	-20.32	MEMBER OFFSETS		-30.35		-30.35
MEMBER124172033 CD4		1	2.57		MEMBER140104135 MD0	1	4.00	1.000	
MEMBER OFFSETS			-20.32	-20.32	MEMBER OFFSETS		-30.35		-30.35
MEMBER124182417 CD4		1	2.57		MEMBER140144211 MD0	1	4.00	1.000	
MEMBER OFFSETS			-20.32	-20.32	MEMBER OFFSETS		-30.35		-30.35
MEMBER124222005 CD4	180.00	1	5.00		MEMBER140394182 MD0	1	4.00,9001.000		-30.35
MEMBER OFFSETS			-20.32	-20.32	MEMBER OFFSETS		-30.35		-30.35
MEMBER124222120 CD4		1			MEMBER140434111 MD0	1	4,002,501.000		-30.35
MEMBER OFFSETS			-20.32	-20.32	MEMBER OFFSETS		-30.35		-30.35
MEMBER188098805 CD4		1			MEMBER140514014 MD0	1	4.00	1.000	
MEMBER OFFSETS			-20.32	-20.32	MEMBER OFFSETS		-30.35		-30.35
MEMBER120012041 CD7		1	7.83		MEMBER140614099 MD0	1	4,002,501.000		-30.35
MEMBER OFFSETS			-31.37	-31.37	MEMBER OFFSETS		-30.35		-30.35
MEMBER120032044 CD7		1	5,432.83		MEMBER140744204 MD0	1	2,001,001.000		-30.35
MEMBER OFFSETS			-31.37	-31.37	MEMBER OFFSETS		-30.35		-30.35
MEMBER120042101 CD7		1	5,601.40		MEMBER140794043 MD0	1	4.00,9001.000		-30.35
MEMBER OFFSETS			-31.37	-31.37	MEMBER OFFSETS		-30.35		-30.35
MEMBER120422002 CD7		1	5,451.13		MEMBER140944019 MD0	1	4,002,501.000		-30.35
MEMBER OFFSETS			-31.37	-31.37	MEMBER OFFSETS		-30.35		-30.35
MEMBER120432004 CD7		1	5,651.40		MEMBER141094074 MD0	1	2,001,001.000		-30.35
MEMBER OFFSETS			-31.37	-31.37	MEMBER OFFSETS		-30.35		-30.35
MEMBER120742003 CD7		1	5,601.40		MEMBER141144042 MD0	1	4,002,501.000		-30.35
MEMBER OFFSETS			-31.37	-31.37	MEMBER OFFSETS		-30.35		-30.35
MEMBER 01213301 CL1		1	7,157.45		MEMBER141244004 MD0	1	2,002,001.000		-30.35
MEMBER 22073001 CL1		1	7,157.45		MEMBER OFFSETS		-30.35		-30.35
MEMBER 22083003 CL1		1	7,157.45		MEMBER141354134 MD0	1	4.00	1.000	
MEMBER 22090121 CL1		1	7,157.45		MEMBER OFFSETS		-30.35		-30.35
MEMBER 22333004 CL1		1	7,157.45		MEMBER141344053 MD0	1	4.00	1.000	
MEMBER 30013172 CL1		1	7,157.45		MEMBER OFFSETS		-30.35		-30.35
MEMBER 30033171 CL1		1	7,157.45		MEMBER141824004 MD0	1	2,002,001.000		-30.35
MEMBER 30043102 CL1		1	7,157.45		MEMBER OFFSETS		-30.35		-30.35
MEMBER 31014002 CL1		1	7,157.45		MEMBER141834070 MD0	1	2.00,9001.000		-30.35
MEMBER 31034001 CL1		1	7,157.45		MEMBER OFFSETS		-30.35		-30.35
MEMBER 31544003 CL1		1	7,157.45		MEMBER142044010 MD0	1	4.00	1.000	
MEMBER 31403102 CL1		1	7,157.45		MEMBER OFFSETS		-30.35		-30.35
MEMBER 31404004 CL1		1	7,157.45		MEMBER142114124 MD0	1	2,002,001.000		-30.35
MEMBER 31713159 CL1		1	7,157.45		MEMBER OFFSETS		-30.35		-30.35
MEMBER 31723103 CL1		1	7,157.45		MEMBER142144019 MD0	1	2.00,9001.000		-30.35
MEMBER 40044210 CL1		1			MEMBER OFFSETS		-30.35		-30.35
MEMBER 42105000 CL1		1	3.00		MEMBER114 4048 MD1	1	4.00	1.000	
MEMBER 20012207 CL3		1	7,157.45		MEMBER OFFSETS		-30.35		-30.35
MEMBER 20022209 CL3		1	7,157.45		MEMBER140014154 MD1	1	4.00	1.000	
MEMBER 20032204 CL3		1	7,157.45		MEMBER OFFSETS		-30.35		-30.35
MEMBER 20042233 CL3		1	7,157.45		MEMBER140014240 MD1				-30.35
MEMBER 01214111 089					MEMBER OFFSETS		-30.35		-30.35
MEMBER 01214112 089					MEMBER140024099 MD1	1	2.00	1.000	
MEMBER 01214115 089					MEMBER OFFSETS		-30.35		-30.35
MEMBER 31024014 089					MEMBER140014000 MD1	1	2,002,001.000		-30.35
MEMBER 31034094 089					MEMBER OFFSETS		-30.35		-30.35
MEMBER 31714004 089					MEMBER140044133 MD1	1	2.00	1.000	
MEMBER 31714010 089					MEMBER OFFSETS		-30.35		-30.35
MEMBER 31724004 089					MEMBER140014081 MD1	1	2.60,9001.000		-30.35
MEMBER 31724007 089		1	3,003.00		MEMBER OFFSETS		-30.35		-30.35
MEMBER 31724009 089					MEMBER140084081 MD1	1	.8001,001.000		-30.35
MEMBER 15002000 011					MEMBER OFFSETS		-30.35		-30.35
MEMBER 900 1000 01A		1	3.00		MEMBER140094044 MD1	1	1.80	1.000	
MEMBER 10003300 01A		1	3.00		MEMBER OFFSETS		-30.35		-30.35
MEMBER 10002002 001					MEMBER140114008 MD1	1	.8001,001.000		-30.35
MEMBER 10002004 001					MEMBER OFFSETS		-30.35		-30.35
MEMBER 20011000 001					MEMBER140274112 MD1	1	4.40	1.000	
MEMBER 20031000 001					MEMBER OFFSETS		-30.35		-30.35
MEMBER 16001019 002					MEMBER140234009 MD1	1	1.80	1.000	
MEMBER10132048 002					MEMBER OFFSETS		-30.35		-30.35
MEMBER OFFSETS			-2.1-315,004-91.44		MEMBER140274011 MD1	1	2,602,601.000		-30.35
MEMBER 10171019 002					MEMBER OFFSETS		-30.35		-30.35
MEMBER 10182053 002					MEMBER140294007 MD1	1	2.40,9001.000		-30.35
MEMBER 10182053 002					MEMBER OFFSETS		-30.35		-30.35
MEMBER110248001 002					MEMBER140324064 MD1	1	2.00	1.000	
MEMBER OFFSETS				-91.44	MEMBER OFFSETS		-30.35		-30.35
MEMBER110258004 002					MEMBER140314045 MD1	1	2.40	1.000	
MEMBER OFFSETS				-2.1-315,004-91.44	MEMBER OFFSETS		-30.35		-30.35
MEMBER110242041 002					MEMBER140444211 MD1	1	1,802,401.000		-30.35
MEMBER OFFSETS				-25.40	MEMBER OFFSETS		-30.35		-30.35
MEMBER110282009 002					MEMBER140464001 MD1	1	2,002,401.000		-30.35
MEMBER OFFSETS				-25.40	MEMBER OFFSETS		-30.35		-30.35
MEMBER 20073039 002					MEMBER1404714 MD1	1	4.00	1.000	
MEMBER 20123015 002					MEMBER OFFSETS		-30.35		-30.35
MEMBER 20143024 002					MEMBER140484159 MD1	1	4.00	1.000	
MEMBER 20283004 002					MEMBER OFFSETS		-30.35		-30.35
MEMBER 21993029 002					MEMBER140544115 MD1	1	2.00	1.000	
MEMBER 30064037 002					MEMBER OFFSETS		-30.35		-30.35
MEMBER 30134032 002					MEMBER140544082 MD1	1	2.40	1.000	
MEMBER 30184134 002					MEMBER OFFSETS		-30.35		-30.35
MEMBER 30194134 002					MEMBER140444077 MD1	1	4.40	1.000	
MEMBER 30244035 002					MEMBER OFFSETS		-30.35		-30.35
MEMBER 30284011 002					MEMBER140614028 MD1	1	2.60	1.000	
MEMBER 30284102 002					MEMBER OFFSETS		-30.35		-30.35
MEMBER 30294100 002					MEMBER140684027 MD1	1	2.00	1.000	
MEMBER 30394023 002					MEMBER OFFSETS		-30.35		-30.35
MEMBER 30424084 002					MEMBER140754054 MD1	1	2.40	1.000	
MEMBER 30434092 002					MEMBER OFFSETS		-30.35		-30.35
MEMBER 30424132 002					MEMBER140774002 MD1	1	2.00	1.000	

MEMBER OFFSETS	-30.35	-30.35	MEMBER140414051 MD2	1	5.00	1.000
MEMBER140814075 MD1	L 2.40	1.000	MEMBER OFFSETS	-20.45	-20.45	
MEMBER OFFSETS	-30.35	-30.35	MEMBER140414060 MD2	L	1.000	-20.45
MEMBER140824003 MD1	L 2.40	1.000	MEMBER OFFSETS	-20.45	-20.45	
MEMBER OFFSETS	-30.35	-30.35	MEMBER140414044 MD2	L 5.00	1.000	-20.45
MEMBER140834044 MD1	L 1.80Z.40Z.000		MEMBER OFFSETS	-20.45	-20.45	
MEMBER OFFSETS	-30.35	-30.35	MEMBER140434097 MD2	L 2.00	1.000	-20.45
MEMBER140844022 MD1	L 6.60	1.000	MEMBER OFFSETS	-20.45	-20.45	
MEMBER OFFSETS	-30.35	-30.35	MEMBER140444024 MD2	L 3.00	1.000	-20.45
MEMBER14124044 MD1	L 6.60	1.000	MEMBER OFFSETS	-20.45	-20.45	
MEMBER OFFSETS	-30.35	-30.35	MEMBER140454040 MD2	L 5.00	1.000	-20.45
MEMBER14124121 MD1	L 2.00	1.000	MEMBER OFFSETS	-20.45	-20.45	
MEMBER OFFSETS	-30.35	-30.35	MEMBER140494096 MD2	L 4.00	1.000	-20.32
MEMBER14124122 MD1	L 2.00	1.000	MEMBER OFFSETS	-20.32	-20.32	
MEMBER OFFSETS	-30.35	-30.35	MEMBER140504086 MD2	L 5.00	1.000	-20.45
MEMBER141224002 MD1	L 2.00	1.000	MEMBER OFFSETS	-20.45	-20.45	
MEMBER OFFSETS	-30.35	-30.35	MEMBER140514042 MD2	L 5.00	1.000	-20.45
MEMBER141334134 MD1	L 2.00	1.000	MEMBER OFFSETS	-20.45	-20.45	
MEMBER OFFSETS	-30.35	-30.35	MEMBER140524125 MD2	L 8.00	1.000	-20.45
MEMBER141344054 MD1	L 2.00	1.000	MEMBER OFFSETS	-20.45	-20.45	
MEMBER OFFSETS	-30.35	-30.35	MEMBER140534119 MD2	L 8.00	1.000	-20.45
MEMBER141544047 MD1	L 8.00	2.000	MEMBER OFFSETS	-20.45	-20.45	
MEMBER OFFSETS	-30.35	-30.35	MEMBER140574058 MD2	L 5.00	1.000	-20.45
MEMBER141594003 MD1	L 8.00	1.000	MEMBER OFFSETS	-20.45	-20.45	
MEMBER OFFSETS	-30.35	-30.35	MEMBER140584061 MD2	L 5.00	1.000	-20.45
MEMBER142134225 MD1	L 2.00Z.40Z.000		MEMBER OFFSETS	-20.45	-20.45	
MEMBER OFFSETS	-30.35	-30.35	MEMBER140594072 MD2	L 2.60	1.000	-20.45
MEMBER142234051 MD1	L 2.00Z.40Z.000		MEMBER OFFSETS	-20.45	-20.45	
MEMBER OFFSETS	-30.35	-30.35	MEMBER140604073 MD2	L 2.60	1.000	-20.45
MEMBER142484004 MD1	L 2.00	1.000	MEMBER OFFSETS	-20.45	-20.45	
MEMBER OFFSETS	-30.35	-30.35	MEMBER140614065 MD2	L 5.00	1.000	-20.45
MEMBER116 187 MD2	L 2.62		MEMBER OFFSETS	-20.45	-20.45	
MEMBER OFFSETS	-12.95	-12.95	MEMBER140634064 MD2	L 5.00	1.000	-20.45
MEMBER1187 403 MD2	L	1.000	MEMBER OFFSETS	-20.45	-20.45	
MEMBER OFFSETS	-20.45	-20.45	MEMBER140644101 MD2	L 2.00	1.000	-20.45
MEMBER140124133 MD2	L 2.75	1.000	MEMBER OFFSETS	-20.45	-20.45	
MEMBER OFFSETS	-20.45	-20.45	MEMBER140644000 MD2	L 2.60	1.000	-20.45
MEMBER140134151 MD2	L .600	1.000	MEMBER OFFSETS	-20.45	-20.45	
MEMBER OFFSETS	-20.45	-20.45	MEMBER140674059 MD2	L 2.60	1.000	-20.45
MEMBER140134260 MD2	L	1.000	MEMBER OFFSETS	-20.45	-20.45	
MEMBER OFFSETS	-20.45	-20.45	MEMBER140694026 MD2	L 5.00	1.000	-20.45
MEMBER14014187 MD2	L	1.000	MEMBER OFFSETS	-20.45	-20.45	
MEMBER OFFSETS	-20.45	-20.45	MEMBER140704080 MD2	L 5.00	1.000	-20.45
MEMBER140164206 MD2	L .600	2.000	MEMBER OFFSETS	-20.45	-20.45	
MEMBER OFFSETS	-20.45	-20.45	MEMBER140714260 MD2	L 2.62	1.000	-20.45
MEMBER140174209 MD2	L 2.75Z.75Z.000		MEMBER OFFSETS	-20.45	-20.45	
MEMBER OFFSETS	-20.45	-20.45	MEMBER140724048 MD2	L 2.40	1.000	-20.45
MEMBER140184107 MD2	L 8.00	1.000	MEMBER OFFSETS	-20.45	-20.45	
MEMBER OFFSETS	-20.45	-20.45	MEMBER140724081 MD2	L 8.00	1.000	-20.45
MEMBER140194091 MD2	L 1.00	2.000	MEMBER OFFSETS	-20.45	-20.45	
MEMBER OFFSETS	-20.45	-20.45	MEMBER140734047 MD2	L 2.40	1.000	-20.45
MEMBER140204021 MD2	L		MEMBER OFFSETS	-20.45	-20.45	
MEMBER OFFSETS	-20.45	-20.45	MEMBER140734072 MD2	L 8.00	1.000	-20.45
MEMBER140204057 MD2	L 5.00	1.000	MEMBER OFFSETS	-20.45	-20.45	
MEMBER OFFSETS	-20.45	-20.45	MEMBER140794070 MD2	L 5.00	1.000	-20.45
MEMBER140214133 MD2	L 2.40Z.000		MEMBER OFFSETS	-20.45	-20.45	
MEMBER OFFSETS	-20.45	-20.45	MEMBER140804014 MD2	L 5.00	1.000	-20.45
MEMBER140224103 MD2	L 2.00	1.000	MEMBER OFFSETS	-20.45	-20.45	
MEMBER OFFSETS	-20.32	-20.32	MEMBER140814079 MD2	L 3.00Z.00Z.000		-20.45
MEMBER140234114 MD2	L 4.00	1.000	MEMBER OFFSETS	-20.45	-20.45	
MEMBER OFFSETS	-20.45	-20.45	MEMBER140834073 MD2	L 8.00	1.000	-20.45
MEMBER140244025 MD2	L 3.00	1.000	MEMBER OFFSETS	-20.45	-20.45	
MEMBER OFFSETS	-20.45	-20.45	MEMBER140854041 MD2	L	1.000	-20.45
MEMBER140254020 MD2	L 3.00	1.000	MEMBER OFFSETS	-20.45	-20.45	
MEMBER OFFSETS	-20.45	-20.45	MEMBER140854050 MD2	L 5.00	1.000	-20.45
MEMBER140264079 MD2	L 5.00	2.000	MEMBER OFFSETS	-20.45	-20.45	
MEMBER OFFSETS	-20.45	-20.45	MEMBER140844023 MD2	L 5.00	1.000	-20.45
MEMBER140294095 MD2	L 5.00	1.000	MEMBER OFFSETS	-20.45	-20.45	
MEMBER OFFSETS	-20.45	-20.45	MEMBER140874103 MD2	L 10.0	1.000	-20.45
MEMBER140294136 MD2	L 2.75Z.000		MEMBER OFFSETS	-20.45	-20.45	
MEMBER OFFSETS	-20.45	-20.45	MEMBER140884087 MD2	L		-20.45
MEMBER140314049 MD2	L 5.00	1.000	MEMBER OFFSETS	-20.45	-20.45	
MEMBER OFFSETS	-20.45	-20.45	MEMBER140904022 MD2	L 4.00Z.00Z.000		-20.45
MEMBER140324021 MD2	L 1.80	1.000	MEMBER OFFSETS	-20.45	-20.45	
MEMBER OFFSETS	-20.45	-20.45	MEMBER140934091 MD2	L	1.000	-20.45
MEMBER140334032 MD2	L 3.80	1.000	MEMBER OFFSETS	-20.45	-20.45	
MEMBER OFFSETS	-20.45	-20.45	MEMBER140944049 MD2	L 4.00	1.000	-20.32
MEMBER140334067 MD2	L 2.60	1.000	MEMBER OFFSETS	-20.32	-20.32	
MEMBER OFFSETS	-20.45	-20.45	MEMBER140954093 MD2	L	1.000	-20.45
MEMBER140344064 MD2	L 2.60	1.000	MEMBER OFFSETS	-20.45	-20.45	
MEMBER OFFSETS	-20.45	-20.45	MEMBER140964131 MD2	L 4.00	1.000	-20.32
MEMBER140344100 MD2	L 8.20Z.50Z.000		MEMBER OFFSETS	-20.32	-20.32	
MEMBER OFFSETS	-20.45	-20.45	MEMBER140974095 MD2	L	1.000	-20.45
MEMBER140354034 MD2	L 4.20	1.000	MEMBER OFFSETS	-20.45	-20.45	
MEMBER OFFSETS	-20.45	-20.45	MEMBER140994097 MD2	L	1.000	-20.45
MEMBER140364035 MD2	L 3.80	1.000	MEMBER OFFSETS	-20.45	-20.45	
MEMBER OFFSETS	-20.45	-20.45	MEMBER141004033 MD2	L 3.80Z.50Z.000		-20.45
MEMBER140364043 MD2	L 5.00	2.000	MEMBER OFFSETS	-20.45	-20.45	
MEMBER OFFSETS	-20.45	-20.45	MEMBER141014099 MD2	L 10.0	1.000	-20.45
MEMBER140374036 MD2	L 3.80	1.000	MEMBER OFFSETS	-20.45	-20.45	
MEMBER OFFSETS	-20.45	-20.45	MEMBER141034101 MD2	L 10.0	1.000	-20.45
MEMBER140374038 MD2	L 5.00	1.000	MEMBER OFFSETS	-20.45	-20.45	
MEMBER OFFSETS	-20.45	-20.45	MEMBER141074108 MD2	L 8.00	1.000	-20.45
MEMBER140384029 MD2	L 5.00	1.000	MEMBER OFFSETS	-20.45	-20.45	
MEMBER OFFSETS	-20.45	-20.45	MEMBER141084137 MD2	L 8.00	1.000	-20.45
MEMBER140394095 MD2	L 2.00	1.000	MEMBER OFFSETS	-20.45	-20.45	
MEMBER OFFSETS	-20.45	-20.45	MEMBER141144094 MD2	L 4.00	1.000	-20.32
MEMBER140404041 MD2	L 5.00	1.000	MEMBER OFFSETS	-20.32	-20.32	
MEMBER OFFSETS	-20.45	-20.45	MEMBER141194120 MD2	L 4.00	1.000	-20.45

MEMBER OFFSETS		-12.95	-12.95	MEMBER130230029 WOL	L	4.202.50	
MEMBER10041000 SDI	L			MEMBER OFFSETS		-20.45	-20.45
MEMBER OFFSETS		-12.95	-12.95	MEMBER130243023 WOL	L	4.20	
MEMBER10071012 SDI	L	3.40		MEMBER OFFSETS		-20.45	-20.45
MEMBER OFFSETS		-12.95	-12.95	MEMBER130243037 WOL	L	2.00	
MEMBER10091010 SDI	L	4.00		MEMBER OFFSETS		-20.45	-20.45
MEMBER OFFSETS		-12.95	-12.95	MEMBER130253041 WOL	L	2.001.00	
MEMBER10091012 SDI	L			MEMBER OFFSETS		-20.45	-20.45
MEMBER OFFSETS		-10.34	-10.34	MEMBER130263014 WOL	L	3.00	
MEMBER10101011 SDI	L	4.00		MEMBER OFFSETS		-20.45	-20.45
MEMBER OFFSETS		-12.95	-12.95	MEMBER130283073 WOL	L	3.002.00	
MEMBER10101013 SDI	L			MEMBER OFFSETS		-20.45	-20.45
MEMBER OFFSETS		-10.34	-10.34	MEMBER130293072 WOL	L	3.002.50	
MEMBER10111014 SDI	L			MEMBER OFFSETS		-20.45	-20.45
MEMBER OFFSETS		-10.34	-10.34	MEMBER130303039 WOL	L	5.00	
MEMBER10111024 SDI	L	4.001.00		MEMBER OFFSETS		-20.45	-20.45
MEMBER OFFSETS		-12.95	-12.95	MEMBER130313040 WOL	L		
MEMBER10121013 SDI	L	3.40		MEMBER OFFSETS		-20.32	-20.32
MEMBER OFFSETS		-12.95	-12.95	MEMBER130343072 WOL	L	3.002.00	
MEMBER10131014 SDI	L	1.40		MEMBER OFFSETS		-20.45	-20.45
MEMBER OFFSETS		-12.95	-12.95	MEMBER130353034 WOL	L	2.002.00	
MEMBER10141029 SDI	L	3.001.00		MEMBER OFFSETS		-20.45	-20.45
MEMBER OFFSETS		-12.95	-12.95	MEMBER130373028 WOL	L	2.00	
MEMBER10151014 SDI	L			MEMBER OFFSETS		-20.45	-20.45
MEMBER OFFSETS		-10.14	-10.14	MEMBER130383040 WOL	L	3.001.00	
MEMBER10151018 SDI	L	3.001.00		MEMBER OFFSETS		-20.45	-20.45
MEMBER OFFSETS		-10.14	-10.14	MEMBER130393031 WOL	L		
MEMBER10161017 SDI	L	1.701.00		MEMBER OFFSETS		-20.45	-20.45
MEMBER OFFSETS		-10.14	-10.14	MEMBER130395059 WOL	L	3.00	
MEMBER10171004 SDI	L	1.001.00		MEMBER OFFSETS		-20.45	-20.45
MEMBER OFFSETS		-10.14	-10.14	MEMBER130403086 WOL	L		
MEMBER10181003 SDI	L	1.001.00		MEMBER OFFSETS		-20.32	-20.32
MEMBER OFFSETS		-10.14	-10.14	MEMBER130413024 WOL	L	3.001.00	
MEMBER10201007 SDI	L	3.40		MEMBER OFFSETS		-20.45	-20.45
MEMBER OFFSETS		-12.95	-12.95	MEMBER130413050 WOL	L	5.00	
MEMBER10211030 SDI	L			MEMBER OFFSETS		-20.45	-20.45
MEMBER OFFSETS		-10.34	-10.34	MEMBER130443048 WOL	L	8.00	
MEMBER10211028 SDI	L	3.001.00		MEMBER OFFSETS		-20.45	-20.45
MEMBER OFFSETS		-12.95	-12.95	MEMBER130453020 WOL	L		
MEMBER10221021 SDI	L	3.00		MEMBER OFFSETS		-20.32	-20.32
MEMBER OFFSETS		-12.95	-12.95	MEMBER130463050 WOL	L		
MEMBER10221023 SDI	L			MEMBER OFFSETS		-20.45	-20.45
MEMBER OFFSETS		-12.95	-12.95	MEMBER130473070 WOL	L	8.00	
MEMBER10231024 SDI	L	1.001.00		MEMBER OFFSETS		-20.45	-20.45
MEMBER OFFSETS		-12.95	-12.95	MEMBER130483014 WOL	L	8.00	
MEMBER10241004 SDI	L	1.001.00		MEMBER OFFSETS		-20.45	-20.45
MEMBER OFFSETS		-12.95	-12.95	MEMBER130493043 WOL	L	8.00	
MEMBER10251004 SDI	L	1.001.00		MEMBER OFFSETS		-20.45	-20.45
MEMBER OFFSETS		-12.95	-12.95	MEMBER130593001 WOL	L	3.00	
MEMBER10261020 SDI	L	3.001.00		MEMBER OFFSETS		-20.45	-20.45
MEMBER OFFSETS		-12.95	-12.95	MEMBER130603015 WOL	L	3.001.00	
MEMBER10281005 SDI	L	4.001.00		MEMBER OFFSETS		-20.45	-20.45
MEMBER OFFSETS		-12.95	-12.95	MEMBER130613001 WOL	L	3.002.00	
MEMBER10114000 SLI	000011000011			MEMBER OFFSETS		-20.45	-20.45
MEMBER10130000 SLI	000011000011			MEMBER130433049 WOL	L	3.001.00	
MEMBER10130005 SLI	000011000011			MEMBER OFFSETS		-20.45	-20.45
MEMBER10140000 SLI	000011000011			MEMBER130433079 WOL	L		
MEMBER11523047 WOL		L	8.00	MEMBER OFFSETS		-20.45	-20.45
MEMBER OFFSETS		-20.45	-20.45	MEMBER130443065 WOL	L		
MEMBER11603007 WOL		L	4.00	MEMBER OFFSETS		-20.45	-20.45
MEMBER OFFSETS		-20.45	-20.45	MEMBER130453063 WOL	L		
MEMBER11613019 WOL		L	4.00	MEMBER OFFSETS		-20.45	-20.45
MEMBER OFFSETS		-20.45	-20.45	MEMBER130483028 WOL	L	3.002.50	
MEMBER13001152 WOL		L	8.00	MEMBER OFFSETS		-20.45	-20.45
MEMBER OFFSETS		-20.45	-20.45	MEMBER130493003 WOL	L	8.00	
MEMBER130013094 WOL		L	4.00	MEMBER OFFSETS		-20.45	-20.45
MEMBER OFFSETS		-20.45	-20.45	MEMBER130503044 WOL	L	8.00	
MEMBER130033078 WOL		L	4.00	MEMBER OFFSETS		-20.45	-20.45
MEMBER OFFSETS		-20.45	-20.45	MEMBER130723048 WOL	L	3.002.00	
MEMBER130043009 WOL		L	5.00	MEMBER OFFSETS		-20.45	-20.45
MEMBER OFFSETS		-20.45	-20.45	MEMBER130733018 WOL	L	2.50	
MEMBER130043024 WOL		L		MEMBER OFFSETS		-20.45	-20.45
MEMBER OFFSETS		-20.45	-20.45	MEMBER130743021 WOL	L	4.00	
MEMBER130083012 WOL		L	5.00	MEMBER OFFSETS		-20.45	-20.45
MEMBER OFFSETS		-20.45	-20.45	MEMBER130793040 WOL	L	4.00	
MEMBER130093011 WOL		L	5.00	MEMBER OFFSETS		-20.45	-20.45
MEMBER OFFSETS		-20.45	-20.45	MEMBER130803018 WOL	L	4.00	
MEMBER130113004 WOL		L	5.00	MEMBER OFFSETS		-20.45	-20.45
MEMBER OFFSETS		-20.45	-20.45	MEMBER130843045 WOL	L		
MEMBER130123030 WOL		L	5.00	MEMBER OFFSETS		-20.32	-20.32
MEMBER OFFSETS		-20.45	-20.45	MEMBER130863042 WOL	L	3.00	
MEMBER130133025 WOL		L	2.00	MEMBER OFFSETS		-20.45	-20.45
MEMBER OFFSETS		-20.45	-20.45	MEMBER13067161 WOL	L	4.00	
MEMBER130133044 WOL		L	5.00	MEMBER OFFSETS		-20.45	-20.45
MEMBER OFFSETS		-20.45	-20.45	MEMBER130873048 WOL	L		
MEMBER130143003 WOL		L	3.00	MEMBER OFFSETS		-20.45	-20.45
MEMBER OFFSETS		-20.45	-20.45	MEMBER130893041 WOL	L	3.003.00	
MEMBER130153044 WOL		L	8.00	MEMBER OFFSETS		-20.45	-20.45
MEMBER OFFSETS		-20.45	-20.45	MEMBER130913018 WOL	L	3.003.00	
MEMBER130153041 WOL		L	3.002.00	MEMBER OFFSETS		-20.45	-20.45
MEMBER OFFSETS		-20.45	-20.45	MEMBER130923087 WOL	L	3.00	
MEMBER130193015 WOL		L	2.50	MEMBER OFFSETS		-20.45	-20.45
MEMBER OFFSETS		-20.45	-20.45	MEMBER13094160 WOL	L	4.00.750	
MEMBER130203042 WOL		L		MEMBER OFFSETS		-20.45	-20.45
MEMBER OFFSETS		-20.32	-20.32	MEMBER11523085 WOL	L	2.00	
MEMBER130213079 WOL		L	4.00	MEMBER OFFSETS		-12.95	-12.95
MEMBER OFFSETS		-20.45	-20.45	MEMBER11604239 WOL	L		
MEMBER130223019 WOL		L	3.00	MEMBER OFFSETS		-12.95	-12.95
MEMBER OFFSETS		-20.45	-20.45	MEMBER11613014 WOL	L		

MEMBER OFFSETS		-12.95	-12.95	MEMBER130443093 W02	L	2.50	-12.95
MEMBER130073021 W02	L			MEMBER OFFSETS			-12.95
MEMBER OFFSETS		-12.95	-12.95	MEMBER130453052 W02	L		-12.95
MEMBER130073043 W02	L	2.40		MEMBER OFFSETS			-12.95
MEMBER OFFSETS		-12.95	-12.95	MEMBER130453096 W02	L		-12.95
MEMBER130083054 W02	L			MEMBER OFFSETS			-12.95
MEMBER OFFSETS		-12.95	-12.95	MEMBER130463095 W02	L		-12.95
MEMBER130083057 W02	L			MEMBER OFFSETS			-12.95
MEMBER OFFSETS		-12.95	-12.95	MEMBER142393044 W02	L	2.40	-12.95
MEMBER130113057 W02	L			MEMBER OFFSETS			-12.95
MEMBER OFFSETS		-12.95	-12.95	PGROUP			
MEMBER130123054 W02	L			PGROUP WPI 1.0002120.000 0.10024.800			
MEMBER OFFSETS		-12.95	-12.95	1.0000-6			
MEMBER130143035 W02	L			*****			
MEMBER OFFSETS		-12.95	-12.95	PGROUP F10 1.0002120.000 0.30024.800			
MEMBER130143094 W02	L	2.50		1.8500			
MEMBER OFFSETS		-12.95	-12.95	PLATE			
MEMBER13020141 W02	L			PLATE A001 4044400141334020095	D		
MEMBER OFFSETS		-12.95	-12.95	PLATE A079 4041400300014044400	D		
MEMBER130223027 W02	L			PLATE A081 4083407340474001095	D		
MEMBER OFFSETS		-12.95	-12.95	PLATE A082 4073407240444047095	D		
MEMBER130233035 W02	L			PLATE A083 4072406140034048895	D		
MEMBER OFFSETS		-12.95	-12.95	PLATE A084 415416 187 4035095	D		
MEMBER130273025 W02	L			PLATE A084 14 41594240387 895	D		
MEMBER OFFSETS		-12.95	-12.95	PLATE A004 4156414442404001950	D		
MEMBER130273032 W02	L			PLATE A010 4044410140074008950	D		
MEMBER OFFSETS		-12.95	-12.95	PLATE A012 4255401740144205950	D		
MEMBER130303038 W02	L			PLATE A018 4032404440314009950	D		
MEMBER OFFSETS		-12.95	-12.95	PLATE A019 4048402740094024950	D		
MEMBER130313095 W02	L			PLATE A020 4033404740324004950	D		
MEMBER OFFSETS		-12.95	-12.95	PLATE A021 4007400940464007950	D		
MEMBER130323024 W02	L			PLATE A022 4034404440334007950	D		
MEMBER OFFSETS		-12.95	-12.95	PLATE A023 400440044004074005950	D		
MEMBER130323044 W02	L			PLATE A024 4035404940344044950	D		
MEMBER OFFSETS		-12.95	-12.95	PLATE A025 4045402940444040950	D		
MEMBER130333027 W02	L			PLATE A026 4036404940394005950	D		
MEMBER OFFSETS		-12.95	-12.95	PLATE A027 40454040400440328950	D		
MEMBER130333034 W02	L			PLATE A028 40274001402240079950	D		
MEMBER OFFSETS		-12.95	-12.95	PLATE A029 40814082400794080050	D		
MEMBER130343032 W02	L			PLATE A030 40824003400800000950	D		
MEMBER OFFSETS		-12.95	-12.95	PLATE A031 4037403040344045950	D		
MEMBER130343044 W02	L			PLATE A032 4038402940404040950	D		
MEMBER OFFSETS		-12.95	-12.95	PLATE A036 4029400540404041950	D		
MEMBER130373031 W02	L			PLATE A039 41364005401364002950	D		
MEMBER OFFSETS		-12.95	-12.95	PLATE A039 4003402140034021950	D		
MEMBER130383034 W02	L			PLATE A040 4211412441254124950	D		
MEMBER OFFSETS		-12.95	-12.95	PLATE A041 4134400441344019950	D		
MEMBER130403052 W02	L			PLATE A042 4004400940019400950	D		
MEMBER OFFSETS		-12.95	-12.95	PLATE A047 40794072400794081950	D		
MEMBER130423040 W02	L			PLATE A049 40044007340054072950	D		
MEMBER OFFSETS		-12.70	-12.70	PLATE A050 40284048340040473050	D		
MEMBER130423043 W02	L			PLATE A051 413240054005740058950	D		
MEMBER OFFSETS		-12.70	-12.70	PLATE A052 4005411940094041950	D		
MEMBER130433045 W02	L			PLATE A054 4119412040414042950	D		
MEMBER OFFSETS		-12.70	-12.70	PLATE A057 4120402240434044950	D		
MEMBER130443047 W02	L			PLATE A058 2055201721050220950	D		
MEMBER OFFSETS		-12.95	-12.95	PLATE A059 2017205422202104950	D		
MEMBER130483049 W02	L			PLATE A060 4249413341644017950	D		
MEMBER OFFSETS		-12.95	-12.95	PLATE A061 41334134420741446950	D		
MEMBER130523092 W02	L			PLATE A062 413440054414442090950	D		
MEMBER OFFSETS		-12.95	-12.95	PLATE A063 40134015142804012950	D		
MEMBER130553074 W02	L	3.00		PLATE A065 4152420041344003950	D		
MEMBER OFFSETS		-12.95	-12.95	PLATE A064 4208414940054211950	D		
MEMBER130563054 W02	L	3.00		PLATE A067 41094182421140044950	D		
MEMBER OFFSETS		-12.95	-12.95	PLATE A048 4149423941904182950	D		
MEMBER130543040 W02	L			PLATE A049 4054412142094147950	D		
MEMBER OFFSETS		-12.95	-12.95	PLATE A070 4185418341478943950	D		
MEMBER130573039 W02	L			PLATE A071 4121400241894183950	D		
MEMBER OFFSETS		-12.95	-12.95	PLATE A072 42084147420841440950	D		
MEMBER130573054 W02	L	3.00		PLATE A073 4147414841484150950	D		
MEMBER OFFSETS		-12.95	-12.95	PLATE A074 4148404341504039950	D		
MEMBER130583059 W02	L	3.00		PLATE A075 40394049400440093950	D		
MEMBER OFFSETS		-12.95	-12.95	PLATE A077 2022202120952017950	D		
MEMBER130583061 W02	L			PLATE A078 20212018201720046950	D		
MEMBER OFFSETS		-12.95	-12.95	PLATE A080 4043409740394097950	D		
MEMBER130593094 W02	L			PLATE A082 4002409940034097950	D		
MEMBER OFFSETS		-12.95	-12.95	PLATE A090 4040404140394083950	D		
MEMBER130613082 W02	L			PLATE A108 4044410140024098950	D		
MEMBER OFFSETS		-12.95	-12.95	PLATE A110 4043400441224002950	D		
MEMBER130643014 W02	L			PLATE A111 4041400441214122950	D		
MEMBER OFFSETS		-12.95	-12.95	PLATE A112 4008404140084122950	D		
MEMBER130653094 W02	L			PLATE A113 40074008412440074950	D		
MEMBER OFFSETS		-12.95	-12.95	PLATE A117 4008404140014010950	D		
MEMBER130653083 W02	L	2.40		PLATE A118 40084001404240084950	D		
MEMBER OFFSETS		-12.95	-12.95	PLATE A119 4086402420464022950	D		
MEMBER130703045 W02	L			PLATE A120 4023400440244114950	D		
MEMBER OFFSETS		-12.95	-12.95	PLATE A121 4034402440254049950	D		
MEMBER130823080 W02	L			PLATE A122 4049402540204131950	D		
MEMBER OFFSETS		-12.95	-12.95	PLATE A123 4131402040074132950	D		
MEMBER130833007 W02	L	2.40		PLATE A124 4020413341344007950	D		
MEMBER OFFSETS		-12.95	-12.95	PLATE A125 400840013413142008950	D		
MEMBER130833079 W02	L			PLATE A126 4205415141524148950	D		
MEMBER OFFSETS		-12.95	-12.95	PLATE A127 4184415242084208950	D		
MEMBER130854239 W02	L	2.40		PLATE A128 4101413541344152950	D		
MEMBER OFFSETS		-12.95	-12.95	PLATE A129 4159400940744071950	D		
MEMBER130933073 W02	L			PLATE A130 40714074413540023950	D		
MEMBER OFFSETS		-12.95	-12.95	PLATE A131 4003400041074109950	D		
MEMBER130943048 W02	L			PLATE A132 41094107410842046950	D		
MEMBER OFFSETS		-12.95	-12.95				

PLATE A133	42044104413741354P10	0		JOINT 2052	0.	-7.	15.	49.974-80.031	10.000					
PLATE A134	4239413741384136P10	0		JOINT 2053	-4.	-9.	15.	-27.153-29.845	10.000					
PLATE A135	4089409040224088P10	0		JOINT 2054	5.	3.	15.	0.004 99.994	10.000					
JOINT				JOINT 2055	4.	3.	15.	0.004 99.993	10.000					
JOINT 14	-4.	0.	22.	0.005	10.000	JOINT 2056	7.	4.	15.	50.048	0.014	10.000		
JOINT 15	-2.	-1.	15.	-48.888-19.965	10.000	JOINT 2057	-3.	-9.	15.	-7.162-30.014	10.000			
JOINT 152	-2.	-2.	18.	-99.990-50.000	80.000	JOINT 2058	-2.	-7.	15.	-7.183-79.999	10.000			
JOINT 160	-2.	-3.	18.	-49.960-99.974	80.000	JOINT 2059	-2.	-3.	15.	-0.005-99.997	10.000			
JOINT 181	0.	-4.	18.	-80.014	-0.020	80.000	JOINT 2060	-1.	-4.	15.	-74.968	-0.011	10.000	
JOINT 185	-1.	-3.	15.	-19.994-99.967	10.000	JOINT 2061	-3.	-3.	15.	-50.470-30.513	10.000			
JOINT 187	-1.	0.	22.	-59.972	-0.141	10.000	JOINT 2062	3.	-3.	15.	50.514-50.469	10.000		
JOINT 900	0.	0.	8.	30.000		JOINT 2063	3.	3.	15.	50.470	50.513	10.000		
JOINT 0002	-8.	-8.	15.	-99.933-29.998	10.000	JOINT 2064	-2.	2.	15.	-50.514	50.469	10.000		
JOINT 0002	100.000	100.000				JOINT 2065	-2.	2.	15.	-67.034	67.049	10.000		
JOINT 0011	-3.	-3.	21.	-54.180-40.422	77.920	KLASTI	JOINT 2066	2.	2.	15.	67.049	67.054	10.000	
JOINT 0012	3.	-3.	21.	34.124-60.866	77.920	JOINT 2067	2.	-2.	15.	67.054-67.049	10.000			
JOINT 0019	-3.	3.	21.	-43.620	34.402	77.920	JOINT 2068	-2.	-2.	15.	-67.049-67.054	10.000		
JOINT 0014	3.	3.	21.	43.201	51.137	77.920	JOINT 2069	-2.	4.	15.	-99.995	0.003	10.000	
JOINT 0121	3.	-4.	20.	99.995	-0.004	10.000	JOINT 2070	-1.	4.	15.	-99.996	0.002	10.000	
JOINT 1000	0.	0.	11.	25.000		JOINT 2071	0.	4.	15.	-99.994	0.001	10.000		
JOINT 1001	0.	-8.	12.	50.051-50.021	80.000	JOINT 2072	0.	3.	15.	0.005	99.999	10.000		
JOINT 1002	2.	-9.	12.	0.012-50.045	50.000	JOINT 2073	1.	3.	15.	0.005	99.998	10.000		
JOINT 1003	0.	-7.	12.	49.987-39.958	50.000	JOINT 2074	2.	3.	15.	0.005	99.997	10.000		
JOINT 1004	1.	-7.	12.	99.978-39.984	50.000	JOINT 2075	3.	3.	15.	0.005	99.996	10.000		
JOINT 1005	2.	-3.	9.	40.041-20.052	95.000	JOINT 2076	-4.	4.	15.	-67.421	87.444	10.000		
JOINT 1006	4.	-3.	9.	40.041-20.004	95.000	JOINT 2077	-1.	-3.	15.	-0.005-99.998	10.000			
JOINT 1007	2.	-1.	9.	40.045-84.984	95.000	JOINT 2078	0.	-4.	15.	-0.005	10.000			
JOINT 1008	4.	-1.	9.	40.044-84.989	95.000	JOINT 2080	0.	-4.	15.	99.994	-0.002	10.000		
JOINT 1009	3.	-3.	9.	40.041-20.003	95.000	JOINT 2081	1.	-4.	15.	99.994	-0.002	10.000		
JOINT 1010	4.	-3.	9.	40.041-20.004	95.000	JOINT 2082	2.	-4.	15.	99.995	-0.003	10.000		
JOINT 1011	5.	-3.	9.	40.042-20.005	95.000	JOINT 2083	-2.	-7.	15.	-25.227-79.971	10.000			
JOINT 1012	3.	-1.	9.	40.045-84.985	95.000	JOINT 2084	-2.	-7.	15.	-90.027-80.027	10.000			
JOINT 1013	4.	-1.	9.	40.045-84.987	95.000	JOINT 2085	0.	-7.	15.	-99.982-80.004	10.000			
JOINT 1014	5.	-1.	9.	40.044-84.988	95.000	JOINT 2086	0.	-7.	15.	0.018-80.008	10.000			
JOINT 1015	0.	-8.	12.	49.982-39.959	50.000	JOINT 2087	1.	-7.	15.	0.018-80.008	10.000			
JOINT 1016	1.	-8.	12.	99.937-39.984	50.000	JOINT 2088	2.	-7.	15.	0.018-80.010	10.000			
JOINT 1017	2.	-7.	12.	0.018-80.010	50.000	JOINT 2089	3.	-7.	15.	0.018-80.011	10.000			
JOINT 1018	0.	-7.	12.	49.974-80.031	50.000	JOINT 2090	-2.	6.	15.	-99.993	0.003	10.000		
JOINT 1019	2.	-7.	14.	0.018-80.010	10.000	JOINT 2091	-1.	6.	15.	-99.993	0.001	10.000		
JOINT 1020	1.	-1.	9.	40.045-84.983	95.000	JOINT 2092	0.	6.	15.	-99.993-492-4	10.000			
JOINT 1021	1.	-3.	9.	40.041-20.001	95.000	JOINT 2093	0.	5.	15.	0.007	99.999	10.000		
JOINT 1022	0.	-3.	9.	50.014-19.949	95.000	JOINT 2094	1.	5.	15.	0.007	99.998	10.000		
JOINT 1023	0.	-1.	9.	50.013-84.971	95.000	JOINT 2095	2.	5.	15.	0.007	99.997	10.000		
JOINT 1024	5.	-1.	9.	99.969-19.998	95.000	JOINT 2096	3.	5.	15.	0.007	99.996	10.000		
JOINT 1025	5.	-1.	9.	99.973-84.980	95.000	JOINT 2097	-3.	-4.	15.	-24.977-54.978	10.000			
JOINT 1026	0.	-1.	9.	99.973-84.974	95.000	JOINT 2098	-2.	-6.	15.	-49.977-54.995	10.000			
JOINT 1028	1.	-3.	9.	99.970-19.991	95.000	JOINT 2099	-1.	-6.	15.	-0.022-57.019	10.000			
JOINT 1500	0.	0.	13.	75.000		JOINT 2100	0.	-6.	15.	-0.022-57.021	10.000			
JOINT 2000	0.	0.	16.	10.000		JOINT 2101	0.	-4.	15.	99.979-57.022	10.000			
JOINT 2001	-4.	-3.	15.	-0.004-99.995	10.000	222000	JOINT 2102	2.	-4.	15.	99.979-57.023	10.000		
JOINT 2002	3.	-4.	15.	99.995	-0.004	10.000	222000	JOINT 2103	2.	-4.	15.	99.979-57.024	10.000	
JOINT 2003	-2.	4.	15.	-99.995	0.004	10.000	222000	JOINT 2104	3.	3.	15.	0.007	99.993	10.000
JOINT 2004	4.	3.	15.	0.004	99.995	10.000	222000	JOINT 2105	4.	3.	15.	0.004	99.992	10.000
JOINT 2005	-7.	-7.	15.	-79.990-80.026	10.000	JOINT 2106	7.	5.	15.	89.942	99.948	10.000		
JOINT 2007	-3.	-7.	15.	-99.982-80.003	10.000	100.000	JOINT 2104	100.000	100.000	KLASTI				
JOINT 2008	4.	-7.	15.	0.018-80.012	10.000	JOINT 2107	8.	4.	15.	67.444	67.421	10.000		
JOINT 2009	1.	-9.	15.	99.970-19.993	10.000	JOINT 2108	5.	0.	15.	0.005	70.030	10.000		
JOINT 2010	5.	-3.	15.	99.994-35.024	10.000	JOINT 2109	4.	1.	15.	0.034	20.038	10.000		
JOINT 2011	-8.	4.	15.	-99.992	0.009	10.000	JOINT 2110	-5.	3.	15.	-70.701	70.711	10.000	
JOINT 2012	-8.	4.	15.	-99.995	0.010	10.000	JOINT 2111	-2.	-3.	15.	-49.980-99.974	10.000		
JOINT 2013	-9.	1.	15.	-99.993	75.010	10.000	JOINT 2112	5.	-1.	15.	0.028-33.324	10.000		
JOINT 2014	-4.	4.	15.	-99.995	0.008	10.000	JOINT 2113	4.	-1.	15.	0.028-33.325	10.000		
JOINT 2015	-8.	-1.	15.	-99.989-74.989	10.000	JOINT 2114	5.	3.	15.	70.711	70.700	10.000		
JOINT 2016	-8.	-3.	15.	-0.004-99.998	10.000	JOINT 2115	-1.	-5.	15.	-74.988-20.022	10.000			
JOINT 2017	4.	4.	15.	74.999	0.020	10.000	JOINT 2120	-8.	-6.	15.	-40.020-57.011	10.000		
JOINT 2018	7.	0.	15.	49.940	70.004	10.000	JOINT 2121	-7.	-4.	15.	-0.021-57.015	10.000		
JOINT 2019	-3.	6.	15.	-99.993	0.004	10.000	JOINT 2122	-3.	-5.	15.	-25.032-20.043	10.000		
JOINT 2020	4.	5.	15.	0.007	99.995	10.000	JOINT 2123	-4.	-4.	15.	-75.021-54.959	10.000		
JOINT 2021	4.	0.	15.	75.005	69.972	10.000	JOINT 2124	-7.	4.	15.	-99.992	0.008	10.000	
JOINT 2022	4.	0.	15.	0.005	70.029	10.000	JOINT 2125	-4.	4.	15.	-99.993	0.007	10.000	
JOINT 2023	-7.	-9.	15.	-79.934-29.972	10.000	JOINT 2126	-5.	6.	15.	-99.993	0.004	10.000		
JOINT 2024	3.	-4.	15.	99.979-57.025	10.000	JOINT 2127	-4.	6.	15.	-99.993	0.005	10.000		
JOINT 2025	-9.	-8.	15.	-0.020-57.020	10.000	JOINT 2128	-2.	1.	15.	-80.004	99.976	10.000		
JOINT 2026	-8.	-7.	15.	-99.981-74.997	10.000	JOINT 2129	-2.	0.	15.	-79.977	42.848	10.000		
JOINT 2027	4.	-2.	15.	0.007-24.917	10.000	JOINT 2130	-2.	0.	15.	-80.041-62.913	10.000			
JOINT 2028	4.	-1.	15.	0.028-33.323	10.000	JOINT 2131	1.	1.	15.	49.939	50.020	10.000		
JOINT 2029	4.	0.	15.	0.005	70.031	10.000	JOINT 2132	1.	-1.	15.	50.020-49.934	10.000		
JOINT 2030	4.	-2.	15.	0.004-24.915	10.000	JOINT 2133	-1.	1.	15.	-50.020	49.934	10.000		
JOINT 2031	-6.	-4.	15.	-25.004	-0.048	10.000	JOINT 2134	-1.	-1.	15.	-49.935-50.020	10.000		
JOINT 2032	-4.	-4.	15.	-74.859	-0.027	10.000	JOINT 2135	0.	1.	15.	-0.021	50.044	10.000	
JOINT 2033	2.	-7.	15.	4.983-60.042	10.000	JOINT 2136	0.	-1.	15.	0.021-60.044	10.000			
JOINT 2034	-7.	4.	15.	-99.995	0.009	10.000	JOINT 2140	-4.	0.	15.	0.005	10.000		
JOINT 2035	-4.	4.	15.	-99.995	0.007	10.000	JOINT 2141	-2.	-2.	15.	-80.011	-0.023	10.000	
JOINT 2036	-3.	4.	15.	-99.995	0.004	10.000	JOINT 2142	-2.	-1.	15.	-0.013-22.001	10.000		
JOINT 2037	-5.	4.	15.	-19.986	0.032	10.000	JOINT 2143	-3.	-1.	15.	-55.022-21.970	10.000		
JOINT 2038	-8.	-3.	15.	-0.004-99.990	10.000	JOINT 2144	-3.	1.	15.	-74.994	22.037	10.000		
JOINT 2039	-7.	-3.	15.	-0.004-99.991	10.000	JOINT 2145	0.	1.	15.	99.979	50.043	10.000		
JOINT 2040	-4.	-1.	15.	-0.004-99.992	10.000	JOINT 2146	1.	-1.	15.	0.027-50.045				

JOINT 2109	3	2	15	0.003	99.996	10.000	JOINT 3026	-6	4	18	-99.995	0.001	80.000	
JOINT 2160	1	-2	15	99.998	-0.002	10.000	JOINT 3027	-8	1	18	-0.054	25.009	80.000	
JOINT 2161	2	-3	15	99.997	-0.003	10.000	JOINT 3028	0	0	18	0.028	19.991	80.000	
JOINT 2162	-2	-1	15	-0.002	-99.997	10.000	JOINT 3029	-8	0	18	-99.972	20.002	80.000	
JOINT 2163	-3	2	15	-99.998	0.002	10.000	JOINT 3030	-4	-7	18	-74.962	-79.966	80.000	
JOINT 2164	-4	-1	15	-0.002	-99.998	10.000	JOINT 3031	-3	-7	18	-25.027	-79.971	80.000	
JOINT 2165	-3	2	15	-99.998	0.004	10.000	JOINT 3032	-7	1	18	-0.054	25.007	80.000	
JOINT 2166	-1	0	15	-99.998	42.892	10.000	JOINT 3033	-8	-1	18	-0.034	-25.036	80.000	
JOINT 2167	-3	0	15	-99.998	42.894	10.000	JOINT 3034	0	-1	18	0.021	-50.044	80.000	
JOINT 2168	-2	0	15	-0.032	-42.887	10.000	JOINT 3035	0	-2	18	0.020	-50.044	80.000	
JOINT 2169	-4	0	15	-0.032	-42.885	10.000	JOINT 3036	-7	-1	18	-0.034	-25.037	80.000	
JOINT 2170	-1	0	15	-50.013	42.868	10.000	JOINT 3037	-8	-3	18	-0.004	-99.990	80.000	
JOINT 2171	-1	0	15	-49.988	-42.865	10.000	JOINT 3038	-7	-3	18	+0.004	-99.991	80.000	
JOINT 2172	-3	2	15	-55.007	0.033	10.000	JOINT 3039	-3	-7	18	-99.982	-80.003	80.000	
JOINT 2173	-3	0	15	-54.977	42.932	10.000	JOINT 3040	-2	-7	18	-50.027	-80.027	80.000	
JOINT 2174	-3	0	15	-54.996	-42.945	10.000	JOINT 3041	-7	3	18	-80.003	99.981	80.000	
JOINT 2175	-3	-1	15	-55.011	-99.867	10.000	JOINT 3042	-2	-9	18	-49.107	-60.029	80.000	
JOINT 2176	-4	1	15	-0.031	75.005	10.000	JOINT 3043	-1	-9	18	-29.114	-60.057	80.000	
JOINT 2177	-3	-1	15	-99.979	-74.994	10.000	JOINT 3044	-6	-1	18	-0.034	-25.038	80.000	
JOINT 2178	-6	1	15	-0.030	75.007	10.000	JOINT 3045	-1	-7	18	-29.052	-80.004	80.000	
JOINT 2179	-6	-1	15	-0.037	-74.992	10.000	JOINT 3046	-8	6	18	-99.933	80.010	80.000	
JOINT 2180	-6	3	15	-0.007	25.004	10.000	JOINT 3047	-4	-1	18	-0.034	-25.040	80.000	
JOINT 2181	-4	-3	15	-0.021	-24.993	10.000	JOINT 3048	-6	1	18	-0.054	25.006	80.000	
JOINT 2182	-4	0	15	-0.057	-74.996	10.000	JOINT 3049	-4	1	18	-0.054	25.004	80.000	
JOINT 2183	-4	0	15	-0.032	74.995	10.000	JOINT 3050	-7	6	18	-80.025	79.982	80.000	
JOINT 2184	-4	0	15	-0.032	74.962	10.000	JOINT 3052	-2	-5	18	-49.993	-95.949	80.000	
JOINT 2185	-4	0	15	-0.054	-74.993	10.000	JOINT 3055	-5	-5	18	-49.992	-99.945	80.000	
JOINT 2186	-4	3	15	-0.007	25.004	10.000	JOINT 3056	-6	-5	18	-25.036	-96.023	80.000	
JOINT 2187	-3	-3	15	-99.992	-24.995	10.000	JOINT 3057	-7	-5	18	-0.037	-99.966	80.000	
JOINT 2188	-3	3	15	-19.998	25.032	10.000	JOINT 3058	-4	-5	18	-74.992	-96.002	80.000	
JOINT 2189	-3	1	15	-20.022	75.033	10.000	JOINT 3059	-4	-5	18	-0.037	-99.970	80.000	
JOINT 2190	-3	0	15	-20.023	74.988	10.000	JOINT 3060	-6	-4	18	-25.004	-0.048	80.000	
JOINT 2191	-5	0	15	-30.002	-75.057	10.000	JOINT 3061	-4	-4	18	-74.959	-0.027	80.000	
JOINT 2192	-3	-1	15	-19.941	-74.964	10.000	JOINT 3062	0	-7	18	0.018	-80.008	80.000	
JOINT 2193	-3	-1	15	-19.983	-24.967	10.000	JOINT 3063	-1	2	18	-60.038	49.992	80.000	
JOINT 2194	-6	-1	15	-99.989	-74.991	10.000	JOINT 3064	-1	-2	18	-60.043	-50.007	80.000	
JOINT 2195	-7	-1	15	-99.989	-74.990	10.000	JOINT 3065	-1	0	18	-59.972	-0.141	80.000	
JOINT 2196	-3	-4	15	-25.004	-0.052	10.000	JOINT 3068	0	0	18			80.000	
JOINT 2197	-4	1	15	-99.993	75.008	10.000	JOINT 3069	-3	2	18	-99.974	49.960	80.000	
JOINT 2198	-7	1	15	-99.993	75.009	10.000	JOINT 3070	-4	0	18			0.006	80.000
JOINT 2199	-8	0	15	-99.972	20.002	10.000	JOINT 3072	0	0	18	0.023	-50.044	80.000	
JOINT 2200	-3	1	15	-99.987	22.010	10.000	JOINT 3073	0	2	18	-0.020	50.044	80.000	
JOINT 2201	-4	-1	15	-0.013	-21.997	10.000	JOINT 3078	-3	3	18	-24.995	99.947	80.000	
JOINT 2202	-3	3	15	-99.967	19.997	10.000	JOINT 3079	-1	3	18	-60.013	99.947	80.000	
JOINT 2206	-4	3	15	-99.994	0.005	10.000	JOINT 3080	0	3	18	-80.005	99.973	80.000	
JOINT 2207	-4	-3	18	-0.004	-99.995	25.000	JOINT 3082	0	2	18	-80.029	50.018	80.000	
JOINT 2208	-3	4	18	-99.995	0.004	25.000	JOINT 3083	-3	2	18	-25.019	49.992	80.000	
JOINT 2209	3	-4	18	99.995	-0.004	25.000	JOINT 3085	-3	-2	18	-25.025	-50.007	80.000	
JOINT 2211	-5	-5	18	-49.988	-19.962	10.000	JOINT 3086	-1	-7	18	-60.045	-79.970	80.000	
JOINT 2217	3	4	15	0.005	99.994	10.000	JOINT 3087	-1	-4	18	-59.977	-0.140	80.000	
JOINT 2220	6	6	15	74.961	0.025	10.000	JOINT 3089	0	-6	18	-0.029	-3.040	80.000	
JOINT 2222	-6	2	15	-0.018	50.007	10.000	JOINT 3091	0	-4	18	0.016	-96.958	80.000	
JOINT 2223	-6	0	15		0.007	10.000	JOINT 3092	-1	-5	18	-39.966	-95.961	80.000	
JOINT 2224	-6	-2	15	-0.040	-49.993	10.000	JOINT 3093	0	2	18	-80.029	50.018	80.000	
JOINT 2225	-4	2	15	-0.010	50.004	10.000	JOINT 3094	0	0	18	-80.009	-0.026	80.000	
JOINT 2226	-3	-2	15	-99.981	-49.995	10.000	JOINT 3095	-3	-5	18	-25.037	-96.024	80.000	
JOINT 2227	-5	-4	15	-19.973	-49.966	10.000	JOINT 3096	-3	-4	18	-25.004	-0.052	80.000	
JOINT 2228	-3	0	15	-19.991	0.033	10.000	JOINT 3101	3	-4	20	99.995	-0.004	87.000	
JOINT 2229	-3	2	15	-20.010	50.033	10.000	JOINT 3102	4	3	20	0.004	99.995	15.000	
JOINT 2230	-2	1	15	-79.996	21.980	10.000	JOINT 3103	-4	-3	21	-0.004	-99.995	22.500	
JOINT 2231	-2	-1	15	-80.022	-22.027	10.000	JOINT 3159	-3	4	21	-99.995	0.004	89.400	
JOINT 2233	4	3	18	0.004	99.995	25.000	JOINT 3160	4	3	21	0.004	99.995	8.900	
JOINT 2234	4	-3	18	99.996	-0.005	10.000	JOINT 3171	-3	4	20	-99.995	0.004	15.000	
JOINT 2235	5	2	15	0.003	99.994	10.000	JOINT 3172	-4	-3	20	-0.004	-99.995	15.000	
JOINT 2236	-4	-3	15		-99.476	10.000	JOINT 4000	-3	4	22	-99.963	90.031	10.000	
JOINT 2240	2	0	15	49.961	70.010	10.000	JOINT 4001	-4	-3	22	+0.004	-99.995	10.000	222000
JOINT 2310	-3	-6	15	-49.976	-56.992	10.000	JOINT 4002	3	-4	22	99.995	-0.004	10.000	222000
JOINT 2311	-4	-6	15	-0.021	-57.816	10.000	JOINT 4003	-3	4	22	-99.995	0.004	10.000	222000
JOINT 2401	4	3	15	0.004	99.993	10.000	JOINT 4004	4	3	22	0.004	99.995	10.000	222000
JOINT 2412	8	-1	15	99.979	-49.961	10.000	JOINT 4005	1	-1	22	99.974	-49.958	10.000	
JOINT 2414	-6	-7	15	-99.981	-80.000	10.000	JOINT 4006	-1	-4	22	+0.636	-0.019	10.000	
JOINT 2415	-6	-7	15	-25.026	-79.967	10.000	JOINT 4007	-6	-4	22	-93.238	-0.014	10.000	
JOINT 2416	-5	-7	15	-50.026	-80.024	10.000	JOINT 4008	-6	3	22	-91.318	99.939	10.000	
JOINT 2417	-6	-5	15	-25.032	-80.038	10.000	JOINT 4009	-3	-6	22	-99.940	-91.318	10.000	
JOINT 2418	-6	-6	15	+25.064	-56.980	10.000	JOINT 4010	-1	4	22	-0.762	0.023	10.000	
JOINT 2419	-7	-4	15	-0.007	-99.991	10.000	JOINT 4011	-6	4	22	-99.995	0.007	10.000	
JOINT 2422	-7	-7	15	-99.981	-79.998	10.000	JOINT 4012	0	2	22	-99.977	32.559	10.000	
JOINT 2455	4	2	15	0.003	99.999	10.000	JOINT 4013	-1	1	22	-59.983	24.993	10.000	
JOINT 3001	-4	-3	18	+0.004	-99.995	80.000	222000	JOINT 4014	1	4	22	0.636	0.019	10.000
JOINT 3003	-3	4	18	-99.995	0.004	80.000	222000	JOINT 4015	0	-1	22	0.021	-50.044	10.000
JOINT 3004	4	3	18	0.004	99.995	93.900	222000	JOINT 4016	-1	-1	22	-60.009	-24.962	10.000
JOINT 3006	-8	-7	18	-99.981	-79.987	80.000	JOINT 4017	0	-2	22	-99.980	-50.043	10.000	
JOINT 3007	-2	2	18	-80.019	49.935	80.000	JOINT 4018	-3	4	22	-99.963	90.031	10.000	
JOINT 3008	-8	-7	18	-25.024	-79.967	80.000	JOINT 4019	4	4	22	0.037	90.022	10.000	
JOINT 3009	-7	-7	18	-99.981	-79.998	80.000	JOINT 4020	-1	-6	22	-0.041	-39.980	10.000	
JOINT 3011	-6	-7	18	-99.981	-80.000	80.000	JOINT 4021	-1	-6	22	-0.039	-22.002	10.000	
JOINT 3012	-3	-7	18	-80.024	-80.024	80.000	JOINT 4022	4	-7	22	0.019	-80.012	10.000	
JOINT 3013	-8	4	18	-99.995	0.010	80.000	JOINT 4023	-3	-7	22	-99.982	-80.003	10.000	
JOINT 3014	-5	4	18	-99.995	0.008	80.000	JOINT 4024	-3	-6	22	-0.061	-39.979	10.000	
JOINT 3015	-8	-3	18	-0.004	-99.993	80.000	JOINT 4025	-2	-6	22	-0.061	-39.979	10.000	
JOINT 3016	0	-2	18	-80.035	-49.981	80.000	JOINT 4026	-7	4	22	-20.043	90.016	10.000	
JOINT 3018	0	3	18	0.005	99.999	80.000	JOINT 4027	-7	4	22	-19.986	0.035	10.000	
JOINT 3019	0	-4	18	-0.003		80.000	JOINT 4028	-7	-3	22	-19.995	-99.964	10.000	
JOINT 3020	0	-7	18	-79.991	-80.034	80.000	JOINT 4029	-7	-7	22	-19.973</			

```

JOINT 4035 -9. -3. 22. -0.004-99.998 10.000
JOINT 4036 -9. -6. 22. -0.015-80.060 10.000
JOINT 4037 -8. -7. 22. -99.998-79.997 10.000
JOINT 4038 -7. -7. 22. -99.998-79.998 10.000
JOINT 4039 4. 1. 22. 0.034 25.040 10.000
JOINT 4040 -7. -6. 22. -29.006-40.036 10.000
JOINT 4041 -6. -6. 22. -29.998-40.010 10.000
JOINT 4042 -4. -6. 22. -79.980-39.998 10.000
JOINT 4043 4. -1. 22. 0.054-25.004 10.000
JOINT 4044 -4. -6. 22. -0.061-39.977 10.000
JOINT 4045 -8. -6. 22. -5.015-40.062 10.000
JOINT 4046 -6. -3. 22. -0.006-99.993 10.000
JOINT 4047 -4. -1. 22. -0.034-25.040 10.000
JOINT 4048 -4. 1. 22. -0.054 25.004 10.000
JOINT 4049 -1. -7. 22. -09.982-80.005 10.000
JOINT 4050 -5. -7. 22. -59.999-80.055 10.000
JOINT 4051 -5. -6. 22. -59.999-39.984 10.000
JOINT 4052 1. 4. 22. 0.037 90.025 10.000
JOINT 4053 1. 3. 22. 0.005 99.999 10.000
JOINT 4054 0. -4. 22. 99.998-0.001 10.000
JOINT 4055 1. -7. 22. 0.018-80.008 10.000
JOINT 4056 -5. 3. 22. -80.013 99.952 10.000
JOINT 4057 0. -6. 22. -0.062-39.982 10.000
JOINT 4058 0. -6. 22. 99.939-39.983 10.000
JOINT 4059 -7. 1. 22. -20.000 24.945 10.000
JOINT 4060 -7. -1. 22. -20.025-25.010 10.000
JOINT 4061 1. -6. 22. 99.939-39.984 10.000
JOINT 4062 3. 0. 22. 99.968-90.032 10.000
JOINT 4063 2. -6. 22. 99.939-39.985 10.000
JOINT 4064 3. -6. 22. 99.939-39.986 10.000
JOINT 4065 -8. -3. 22. -0.004-99.990 10.000
JOINT 4066 -8. -1. 22. -0.034-25.036 10.000
JOINT 4067 -8. 1. 22. -0.054 25.009 10.000
JOINT 4068 -7. 4. 22. -99.995 0.009 10.000
JOINT 4069 -7. 4. 22. -99.963 90.035 10.000
JOINT 4070 -5. 4. 22. -59.980 89.979 10.000
JOINT 4071 -2. 2. 22. -31.372 32.501 10.000
JOINT 4072 -6. 1. 22. -39.991 24.972 10.000
JOINT 4073 -6. -1. 22. -40.017-24.984 10.000
JOINT 4074 -2. 4. 22. -31.436 0.031 10.000
JOINT 4075 -5. 4. 22. -99.995 0.006 10.000
JOINT 4077 3. -6. 22. 99.993 -0.004 10.000
JOINT 4078 3. -2. 22. 99.998 -0.004 10.000
JOINT 4079 -4. 4. 22. -39.989 89.953 10.000
JOINT 4080 -4. 4. 22. -79.972 80.005 10.000
JOINT 4081 -6. 4. 22. -39.977 0.561 10.000
JOINT 4082 -4. 3. 22. -80.004 99.978 10.000
JOINT 4083 -6. -3. 22. -39.987-99.938 10.000
JOINT 4084 -2. -9. 22. -49.107-60.029 10.000
JOINT 4085 -6. -7. 22. -40.053-79.990 10.000
JOINT 4086 -4. -7. 22. -79.990-80.029 10.000
JOINT 4087 4. -9. 22. 99.962-19.996 10.000
JOINT 4088 3. -9. 22. 99.942-19.994 10.000
JOINT 4089 3. -9. 22. 60.025-20.029 10.000
JOINT 4090 3. -7. 22. 99.946-80.003 10.000
JOINT 4091 5. 4. 22. 0.036 90.021 10.000
JOINT 4092 -1. -9. 22. -29.116-80.057 10.000
JOINT 4093 5. 3. 22. 0.004 99.994 10.000
JOINT 4094 -2. -7. 22. -49.132-80.021 10.000
JOINT 4095 5. 1. 22. 0.034 25.039 10.000
JOINT 4096 -1. -7. 22. -29.952-80.004 10.000
JOINT 4097 5. -1. 22. 0.054-25.005 10.000
JOINT 4098 4. 1. 22. 0.024 8.741 10.000
JOINT 4099 4. -8. 22. 99.995 -0.005 10.000
JOINT 4100 -8. 0. 22. -99.972 20.002 10.000
JOINT 4101 4. -6. 22. 99.939-39.987 10.000
JOINT 4102 0. 0. 22. 0.028 19.991 10.000
JOINT 4103 5. -7. 22. 0.018-80.013 10.000
JOINT 4107 -2. 4. 22. -99.963 90.030 10.000
JOINT 4108 -1. 4. 22. -99.963 90.029 10.000
JOINT 4109 -2. 4. 22. -99.995 0.003 10.000
JOINT 4111 4. -1. 22. 0.065 -8.725 10.000
JOINT 4112 3. -6. 22. 99.926-91.283 10.000
JOINT 4114 -2. -7. 22. -99.982-80.004 10.000
JOINT 4115 1. -4. 22. 8.762 -0.023 10.000
JOINT 4119 2. -7. 22. 0.018-80.010 10.000
JOINT 4120 3. -7. 22. 0.018-80.011 10.000
JOINT 4121 1. -4. 22. 99.996 -0.002 10.000
JOINT 4122 2. -4. 22. 99.999 -0.003 10.000
JOINT 4124 3. 3. 22. 0.005 99.996 10.000
JOINT 4125 2. 4. 22. 0.037 90.024 10.000
JOINT 4126 3. 4. 22. 0.037 90.023 10.000
JOINT 4131 0. -7. 22. -99.982-80.006 10.000
JOINT 4132 0. -7. 22. 0.018-80.008 10.000
JOINT 4133 -1. -3. 22. -0.005-99.998 10.000
JOINT 4134 0. -4. 22. -0.005 10.000
JOINT 4135 0. 4. 22. -99.996 0.001 10.000
JOINT 4136 0. 3. 22. 0.005 99.999 10.000
JOINT 4137 0. 4. 22. -99.964 90.027 10.000
JOINT 4138 0. 4. 22. 0.037 90.026 10.000
JOINT 4146 0. -1. 22. 0.059-24.999 10.000
JOINT 4147 2. -1. 22. 0.059-25.002 10.000
JOINT 4148 3. -1. 22. 0.054-25.003 10.000
JOINT 4149 2. 1. 22. 0.035 25.043 10.000
JOINT 4150 3. 1. 22. 0.035 25.041 10.000
JOINT 4151 -1. 1. 22. -0.055 25.001 10.000
JOINT 4152 0. 1. 22. -0.055 24.999 10.000
JOINT 4156 -3. -2. 22. -99.980-50.046 10.000
JOINT 4159 -3. 2. 22. -99.976 32.563 10.000
JOINT 4166 -1. -2. 22. -99.980-50.042 10.000
JOINT 4167 -3. 2. 22. -32.498 32.466 10.000
JOINT 41A0 1. 2. 22. 99.978 15.024 10.000
JOINT 41A1 2. 2. 22. 99.978 15.023 10.000
JOINT 41A2 3. 2. 22. 99.978 15.022 10.000
JOINT 41A3 4. -2. 22. 0.041-17.890 10.000
JOINT 41A4 3. -2. 22. 0.041-17.889 10.000
JOINT 41A5 2. -2. 22. 0.041-17.888 10.000
JOINT 4203 0. -1. 22. -99.944-24.998 10.000
JOINT 4206 -1. 4. 22. -99.996 0.002 10.000
JOINT 4208 0. 1. 22. 99.946 24.998 10.000
JOINT 4209 1. -1. 22. 0.055-25.001 10.000
JOINT 4210 4. 3. 23. 0.004 99.995 40.500
JOINT 4211 2. 3. 22. 0.005 99.997 10.000
JOINT 4213 -4. -5. 22. -0.007-99.995 10.000
JOINT 4214 4. 4. 20. 0.009 70.031 10.000
JOINT 4223 -4. -4. 22. -0.040-48.305 10.000
JOINT 4234 -2. -2. 18. -49.934-50.019 80.000
JOINT 4240 -2. -3. 22. -0.005-99.997 10.000
JOINT 4255 -1. -2. 22. -60.043-50.007 10.000
JOINT 42A0 -1. 2. 22. -59.984 32.506 10.000
JOINT 5000 4. 3. 23. 0.004 99.995 21.000
JOINT BR01 5. -3. 15. 99.969-19.998 10.000
JOINT BR02 4. -3. 15. 99.969-19.996 10.000
JOINT BR03 3. -3. 15. 99.969-19.995 10.000
JOINT BR04 3. -3. 15. 19.961-20.021 10.000
JOINT BR05 3. -4. 15. 99.941-39.989 10.000
JOINT BR06 5. -2. 15. 99.997 -0.007 10.000
JOINT BR08 4. -4. 15. 99.941-39.988 10.000
JOINT BR09 2. -2. 15. 99.994 -0.003 10.000
JOINT BR10 3. -2. 15. 99.998 -0.004 10.000
JOINT BR11 4. -2. 15. 99.997 -0.005 10.000
JOINT BR00 -1. 0. 32. -34.847-67.172 78.164 113111
CDM
*****
*****
**** CD/CM (API RP2A-MSD) WITH 5% INCREASED FOR UN-MODELLED
APPROXIMANCES ****
*****
CDM 2.94 0.683 1.680 1.103 1.260
CDM 304.90 0.683 1.680 1.103 1.260
LOAD
LOADCN 1
SEAD
SEAD -S M
*
*****
* STRUCTURAL NON-MODEL WEIGHTS
*
*****
LOADCN 11
***L0S1** -6.799 1.732 1.030 -7.714 -0.322 1.030
-5.155
***L0S2** 1.000 1.030 -8.070 -1.055 1.030 -0.450
-0.450
***L0S3** 0.305 50 3 3 1 111 -2EQOFFRESGRATING
***L0S1** -5.884 3.788 2.230 -6.799 1.732 2.230
-4.240
***L0S2** 3.054 2.230 -5.155 1.000 2.230 -0.450
-0.450
***L0S3** 0.305 50 3 3 1 111 -2EQOFFRESGRATING
***L0S1** -4.155 3.430 3.430 -5.884 3.788 3.430
-2.511
***L0S2** 4.978 3.430 -4.240 3.054 3.430 -0.450
-0.450
***L0S3** 0.305 50 3 3 1 111 -2EQOFFRESGRATING
*****
* STRUCTURAL NON-MODEL WEIGHTS
*
*****
LOADCN 21
LOAD 4003 -20.355 GLOB JOIN
JD-ME
LOAD 4004 -20.355 GLOB JOIN
JD-ME
LOAD 4002 -20.355 GLOB JOIN
JD-ME
LOAD 4001 -20.355 GLOB JOIN
JD-ME
LOAD 4001 -19.613 GLOB JOIN
PADEYE
LOAD 4003 -19.613 GLOB JOIN
PADEYE
LOAD 4004 -19.613 GLOB JOIN
PADEYE
LOAD 4002 -19.613 GLOB JOIN
PADEYE
LOAD Z 40184107 -0.2500 -0.2500 GLOB UNIF
RRAIL
LOAD Z 40194091 -0.2500 -0.2500 GLOB UNIF
RRAIL
LOAD Z 40244079 -0.2500 -0.2500 GLOB UNIF
RRAIL

```

Lampiran 3 SACS OUTPUT

SACS-IV MEMBER UNITY CHECK RANGE SUMMARY

GROUP I - UNITY CHECKS GREATER THAN 0.00 AND LESS THAN 0.80															
MEMBER	GROUP ID	MAXIMUM COMBINED UNITY CK	LOAD COND NO.	DIST FROM END	AXIAL STRESS N/MM2	BENDING Y N/MM2	STRESS Z N/MM2	SHEAR FY KN	FORCE FZ KN	KLY/RZ	KLZ/RZ	SECOND-HIGHEST UNITY CHECK	HIGHEST LOAD COND	THIRD-HIGHEST UNITY CHECK	HIGHEST LOAD COND
3121-3117	WD2	0.440	AP00	3.8	0.65	-45.78	-14.18	-0.50	-9.51	35.1	112.9	0.357	BP00	0.220	DEAD
3122-3118	WD2	0.722	AP00	3.8	-0.17	-83.93	-9.90	-0.36	-31.47	35.1	112.9	0.587	BP00	0.361	DEAD
3123-3110	WD2	0.091	AP00	0.0	-1.25	6.26	9.45	-0.87	-0.06	13.8	44.5	0.074	BP00	0.046	DEAD
3123-3124	WD2	0.402	AP00	0.8	-1.26	46.46	21.73	4.06	4.49	7.4	23.8	0.326	BP00	0.201	DEAD
3124-3112	WD2	0.241	AP00	0.0	0.04	21.26	22.80	-2.14	-4.37	13.8	44.5	0.196	BP00	0.121	DEAD
3124-3125	WD2	0.475	AP00	0.8	-1.06	54.47	26.62	4.26	3.25	7.4	23.8	0.386	BP00	0.237	DEAD
3125-3113	WD2	0.228	AP00	0.0	-0.06	16.43	26.10	-2.54	-2.29	13.8	44.5	0.185	BP00	0.114	DEAD
3125-3126	WD2	0.460	AP00	0.0	-0.76	54.48	-23.63	4.02	-0.91	7.4	23.8	0.374	BP00	0.230	DEAD
3126-3114	WD2	0.182	AP00	1.5	-1.49	-1.78	-34.37	-2.65	-1.73	13.8	44.5	0.148	BP00	0.091	DEAD
3126-3127	WD2	0.426	AP00	0.0	-0.39	50.42	-22.11	5.29	-23.13	7.4	23.8	0.346	BP00	0.213	DEAD
3130-3123	WD2	0.300	AP00	0.6	-2.11	34.77	10.62	-1.04	6.13	23.1	74.3	0.244	BP00	0.150	DEAD
3130-3131	WD2	0.479	AP00	0.8	-0.49	60.43	19.77	3.52	1.42	7.4	23.8	0.389	BP00	0.240	DEAD
3131-3124	WD2	0.392	AP00	0.0	0.00	39.82	25.09	-1.30	-1.11	23.1	74.3	0.319	BP00	0.196	DEAD
3131-3132	WD2	0.557	AP00	0.8	-0.40	70.46	22.93	3.70	4.21	7.4	23.8	0.453	BP00	0.279	DEAD
3132-3125	WD2	0.378	AP00	0.0	0.00	37.92	24.64	-1.27	-0.06	23.1	74.3	0.307	BP00	0.189	DEAD
3132-3133	WD2	0.571	AP00	0.8	-0.31	71.99	23.81	3.48	-4.14	7.4	23.8	0.464	BP00	0.285	DEAD
3133-3126	WD2	0.267	AP00	0.6	-1.79	30.43	10.37	-1.10	4.75	23.1	74.3	0.217	BP00	0.133	DEAD
3133-3134	WD2	0.498	AP00	0.0	-0.18	72.01	-8.18	2.62	-29.44	7.4	23.8	0.405	BP00	0.249	DEAD
3137-3130	WD2	0.280	AP00	1.9	-2.21	34.23	-7.04	-0.80	-5.80	23.1	74.3	0.227	BP00	0.140	DEAD
3137-3138	WD2	0.396	AP00	0.0	-0.78	47.51	-19.44	3.11	-2.72	7.4	23.8	0.322	BP00	0.198	DEAD
3138-3131	WD2	0.356	AP00	2.5	-0.05	39.82	-17.24	-0.90	2.76	23.1	74.3	0.289	BP00	0.178	DEAD
3138-3139	WD2	0.356	AP00	0.0	-1.04	40.62	-20.12	3.19	-0.33	7.4	23.8	0.289	BP00	0.178	DEAD

* SACS-IV MEMBER UNITY CHECK RANGE SUMMARY

GROUP I - UNITY CHECKS GREATER THAN 0.00 AND LESS THAN 0.80															
MEMBER	GROUP ID	MAXIMUM COMBINED UNITY CK	LOAD COND NO.	DIST FROM END	AXIAL STRESS N/MM2	BENDING Y N/MM2	STRESS Z N/MM2	SHEAR FY KN	FORCE FZ KN	KLY/RZ	KLZ/RZ	SECOND-HIGHEST UNITY CHECK	HIGHEST LOAD COND	THIRD-HIGHEST UNITY CHECK	HIGHEST LOAD COND
3139-3132	WD2	0.342	AP00	2.5	0.05	37.92	-17.28	-0.91	1.32	23.1	74.3	0.278	BP00	0.171	DEAD
3139-3140	WD2	0.342	AP00	0.8	-1.18	34.40	25.54	3.35	-6.95	7.4	23.8	0.278	BP00	0.171	DEAD
3140-3133	WD2	0.252	AP00	1.9	-1.58	31.38	-5.79	-0.55	-5.33	23.1	74.3	0.205	BP00	0.126	DEAD
3140-3141	WD2	0.290	AP00	0.0	-1.08	34.41	14.35	-2.60	-12.06	7.4	23.8	0.236	BP00	0.145	DEAD
3182-3055	WD2	0.117	AP00	0.9	0.34	-14.08	-5.70	-0.49	-6.90	27.7	26.7	0.095	BP00	0.059	DEAD
3182-3060	WD2	0.067	AP00	0.0	1.44	1.10	-11.50	0.63	2.97	21.2	68.3	0.054	BP00	0.033	DEAD
4239-3064	WD2	0.134	AP00	0.8	-0.24	-7.16	-18.67	-2.12	-4.91	22.2	23.8	0.109	BP00	0.067	DEAD

* SACS-IV MEMBER UNITY CHECK RANGE SUMMARY

GROUP II - UNITY CHECKS GREATER THAN 0.80 AND LESS THAN 1.00															
MEMBER	GROUP ID	MAXIMUM COMBINED UNITY CK	LOAD COND NO.	DIST FROM END	AXIAL STRESS N/MM2	BENDING Y N/MM2	STRESS Z N/MM2	SHEAR FY KN	FORCE FZ KN	KLY/RZ	KLZ/RZ	SECOND-HIGHEST UNITY CHECK	HIGHEST LOAD COND	THIRD-HIGHEST UNITY CHECK	HIGHEST LOAD COND
3015-3001	WD1	0.957	AP00	2.4	-2.94	-205.28	-4.09	-0.50	-142.81	16.4	57.5	0.777	BP00	0.478	DEAD

* SACS-IV MEMBER UNITY CHECK RANGE SUMMARY

GROUP III - UNITY CHECKS GREATER THAN 1.00															
MEMBER	GROUP ID	MAXIMUM COMBINED UNITY CK	LOAD COND NO.	DIST FROM END	AXIAL STRESS N/MM2	BENDING Y N/MM2	STRESS Z N/MM2	SHEAR FY KN	FORCE FZ KN	KLY/RZ	KLZ/RZ	SECOND-HIGHEST UNITY CHECK	HIGHEST LOAD COND	THIRD-HIGHEST UNITY CHECK	HIGHEST LOAD COND
1041-1042	SD1	1.464	AP00	0.0	-41.18	219.13	37.72	-2.80	-150.44	9.2	29.7	1.189	BP00	0.740	DEAD
1042-1043	SD1	1.147	AP00	0.0	-1.89	-190.41	25.95	-2.07	42.95	9.2	29.7	0.932	BP00	0.574	DEAD
1050-1031	SD1	1.068	AP00	1.0	-0.33	153.07	-57.87	-4.65	22.18	9.2	29.7	0.868	BP00	0.534	DEAD

*** MEMBER GROUP SUMMARY ***
WSD AISC 14th / API RP2A-WSD 22ND

GRP ID	CRITICAL MEMBER	LOAD COND	MAX. UNITY CHECK	DIST FROM END M	* APPLIED STRESSES *			*** ALLOWABLE STRESSES ***				CRIT COND	EFFECTIVE LENGTHS		* CM VALUES *	
					AXIAL N/MM2	BEND-Y N/MM2	BEND-Z N/MM2	AXIAL N/MM2	EULER N/MM2	BEND-Y N/MM2	BEND-Z N/MM2		KLY M	KLZ M	Y	Z
BRD	2051-0501	AP00	0.07	0.0	-0.3	-8.4	10.9	190.0	2370.3	237.0	323.0	CM+BN	8.30	1.50	1.00	1.00
BS1	2002-2050	AP00	0.19	0.0	-0.9	-28.5	-30.5	202.1	4156.7	309.9	309.9	CM+BN	8.30	1.00	1.00	1.00
CD0	2455-2004	AP00	0.12	1.0	-0.3	-26.8	-2.9	168.2	492.2	237.0	323.0	CM+BN	8.00	3.30	1.00	1.00
CD1	2032-2001	AP00	0.62	0.7	-4.2	-128.2	-19.6	201.0	3275.2	232.8	316.9	CM+BN	5.00	0.75	1.00	1.00
CD2	2014-2003	AP00	0.45	1.0	-0.7	-103.0	4.0	189.4	2898.7	236.9	322.7	CM+BN	5.00	1.00	1.00	1.00
CD3	2252-2301	AP00	0.55	0.5	-0.7	37.1	79.5	162.7	5868.0	183.3	252.8	CM+BN	0.50	0.50	1.00	1.00
CD5	2061-2068	AP00	0.11	0.0	-4.4	-16.5	-8.5	202.2	4200.2	227.0	311.4	CM+BN	1.18	2.83	1.00	1.00
CD6	2250-2262	AP00	0.41	0.0	1.0	84.8	-15.3	206.6	3319.4	235.2	320.7	TN+BN	0.82	0.82	1.00	1.00
CD7	2001-2061	AP00	0.08	0.0	-2.6	-13.2	-3.2	.2E+03	.1E+05	.2E+03	.2E+03	CM+BN	0.70	2.83	1.00	1.00
CL1	3172-3103	AP00	0.36	0.0	44.3	-34.7	-12.7	207.0	1256.0	259.7	259.7	TN+BN	7.15	7.65	0.85	0.85
CL3	2002-3002	AP00	0.23	0.0	13.3	6.4	-41.2	207.0	1275.9	250.2	250.2	TN+BN	7.15	7.65	0.85	0.85
DBR	3172-4007	AP00	0.50	3.5	-44.3	-74.3	-5.7	207.0	2289.4	258.8	258.8	C>.15B	3.00	3.00	0.85	0.85
DL1	1500-2000	AP00	0.02	2.2	-0.5	0.3	3.2	.2E+03	.6E+05	.2E+03	.2E+03	C<.15	2.20	2.20	0.85	0.85
DLA	1000-1500	AP00	0.01	0.0	-0.8	-0.5	-1.1	.2E+03	.3E+05	.3E+03	.3E+03	C<.15	3.00	2.00	0.85	0.85
DS1	2001-1000	AP00	0.13	0.0	5.2	-25.7	9.9	207.0	1480.8	259.7	259.7	TN+BN	7.05	7.05	0.85	0.85
HG1	3042-4084	AP00	0.35	0.0	0.1	64.4	-3.6	148.8	491.1	186.0	186.0	TN+BN	3.50	3.50	0.85	0.85
HG2	3024-4123	AP00	0.34	3.5	6.5	0.1	-107.0	270.0	945.7	337.5	337.5	TN+BN	3.30	3.50	0.85	0.85
HG3	1042-1002	AP00	0.78	0.0	47.3	85.5	-14.0	148.8	1594.3	186.0	186.0	TN+BN	1.41	1.41	0.85	0.85
MD0	4010-4135	AP00	0.27	0.0	-13.5	-11.7	-5.4	202.8	4873.7	232.8	316.9	SHEAR	4.00	0.09	1.00	1.00
MD1	4028-4007	AP00	0.66	0.3	-65.4	-72.3	13.2	190.8	4506.4	236.9	322.7	CM+BN	4.10	0.80	1.00	1.00
MD2	4003-4073	AP00	0.44	0.0	-17.1	-87.6	0.7	152.7	298.8	235.2	320.7	CM+BN	8.00	2.75	1.00	1.00
MD3	4040-4028	AP00	0.31	2.4	-15.3	-43.1	-2.4	124.2	254.7	183.3	252.8	CM+BN	2.40	2.40	1.00	1.00
SD1	1041-1042	AP00	1.46	0.0	-41.2	219.1	37.7	156.8	1468.0	183.3	252.8	CM+BN	1.00	1.00	1.00	1.00

*** MEMBER GROUP SUMMARY ***
WSD AISC 14th / API RP2A-WSD 22ND

GRP ID	CRITICAL MEMBER	LOAD COND	MAX. UNITY CHECK	DIST FROM END M	* APPLIED STRESSES *			*** ALLOWABLE STRESSES ***				CRIT COND	EFFECTIVE LENGTHS		* CM VALUES *	
					AXIAL N/MM2	BEND-Y N/MM2	BEND-Z N/MM2	AXIAL N/MM2	EULER N/MM2	BEND-Y N/MM2	BEND-Z N/MM2		KLY M	KLZ M	Y	Z
MD1	3015-3001	AP00	0.96	2.4	-2.9	-205.3	-4.1	163.3	392.2	220.4	320.7	CM+BN	3.00	2.40	1.00	1.00
MD2	3122-3110	AP00	0.72	3.0	-0.2	-83.9	-9.9	74.6	96.0	124.7	216.0	CM+BN	3.00	3.00	1.00	1.00

Lampiran 4 SLING TENSION FORCE

SACS-IV SYSTEM: MEMBER FORCES AND MOMENTS

MEMBER NUMBER	MEMBER END	GROUP ID	LOAD CASE	KN			KN-M		
				FORCE(X)	FORCE(Y)	FORCE(Z)	MOMENT(X)	MOMENT(Y)	MOMENT(Z)
4001- HK1	4001	SLG	DEAD	1450.64	0.00	0.00	0.01	0.00	0.00
			AP00	2901.27	0.00	0.00	0.03	0.00	0.00
			BP00	2357.27	0.00	0.00	0.02	0.00	0.00
	HK1	DEAD	DEAD	1450.64	0.00	0.00	0.01	0.00	0.00
			AP00	2901.27	0.00	0.00	0.03	0.00	0.00
			BP00	2357.27	0.00	0.00	0.02	0.00	0.00
4002- HK2	4002	SLG	DEAD	646.34	0.00	0.00	-0.01	0.00	0.00
			AP00	1292.68	0.00	0.00	-0.01	0.00	0.00
			BP00	1050.30	0.00	0.00	-0.01	0.00	0.00
	HK2	DEAD	DEAD	646.34	0.00	0.00	-0.01	0.00	0.00
			AP00	1292.68	0.00	0.00	-0.01	0.00	0.00
			BP00	1050.30	0.00	0.00	-0.01	0.00	0.00
4003- HK1	4003	SLG	DEAD	998.63	0.00	0.00	-0.10	0.00	0.00
			AP00	1997.26	0.00	0.00	-0.21	0.00	0.00
			BP00	1622.76	0.00	0.00	-0.17	0.00	0.00
	HK1	DEAD	DEAD	998.63	0.00	0.00	-0.10	0.00	0.00
			AP00	1997.26	0.00	0.00	-0.21	0.00	0.00
			BP00	1622.76	0.00	0.00	-0.17	0.00	0.00
4004- HK2	4004	SLG	DEAD	440.00	0.00	0.00	-0.09	0.00	0.00
			AP00	881.59	0.00	0.00	-0.18	0.00	0.00
			BP00	716.30	0.00	0.00	-0.15	0.00	0.00
	HK2	DEAD	DEAD	440.00	0.00	0.00	-0.09	0.00	0.00
			AP00	881.59	0.00	0.00	-0.18	0.00	0.00
			BP00	716.30	0.00	0.00	-0.15	0.00	0.00